

**ILLINOIS DEPARTMENT OF PUBLIC HEALTH
AHERA THREE YEAR REINSPECTION
ASBESTOS ABATEMENT PROGRAM
SCHOOL INFORMATION FORM**

SECTION I

NAME OF SCHOOL DISTRICT: CHICAGO SCHOOL DIST 299
SCHOOL ID NUMBER: 14-016-2990-423X
SCHOOL NAME: Chicago International Charter - Wrightwood
ADDRESS OF SCHOOL: 8130 S. California Ave.
CITY: Chicago, IL, 60652

DATE LAST THREE YEAR REINSPECTION WAS COMPLETED 2/25/2010

If the address on this form is different than the address of the building, submit a written explanation.

SECTION II (Please type or print)

PLEASE COMPLETE THE FOLLOWING FOR YOUR THREE YEAR REINSPECTION:

DATE REINSPECTION COMPLETED: 8/13/2013 ENROLLMENT 731
IDPH INSPECTOR LICENSE NUMBER: 100-08904
IDPH LICENSED INSPECTOR NAME (Please Print): Douglas McCormick
IDPH MP LICENSE NUMBER: 100-09870
IDPH LICENSED MANAGEMENT PLANNER NAME (Please Print): Todd Huffer

DESIGNATED PERSON (Please Print): Ms. Lynn Crivello PHONE: (773) 553-3113

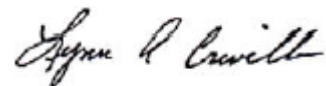

8/13/2013

Signature of Designated Person

Date

SECTION III

PLEASE COMPLETE THE FOLLOWING INFORMATION FOR ANY CHANGES WITHIN THE SCHOOL DISTRICT.

School building has been sold. Date of Sale: _____

School has been closed. Date closed: _____

School building has been demolished. Date: _____

School building is asbestos free since last reinspection: _____

Please explain in writing why the school building is now asbestos free and include the supporting documentation.

If a new school building has been added to the district, submit either an exclusionary statement or a management plan and inspection report. Include the complete name, address and city of school building.

Explain in writing if the address of the building is different than the address on this form:

THREE-YEAR REINSPECTION

CHICAGO SCHOOL DIST 299

Chicago International Charter - Wrightwood

8130 S. California Ave.
Chicago, IL, 60652

Unit: 66381
Building ID: 3180

IDPH ID Number: 14-016-2990-423X

REPORT DATE:

Tuesday, August 13, 2013

Prepared for:

Chicago Public Schools
125 S. Clark Street
Chicago, IL 60603

Prepared by:

Carnow, Conibear and Associates

600 West Van Buren St., Ste 500

Phone (312) 762-2900

Fax (312) 782-5145

**DO NOT REMOVE FROM SCHOOL
REQUIRED BY FEDERAL LAW**

August 13, 2013

Mr. R. Kent Cook
Asbestos Program
Illinois Department of Public Health
525 West Jefferson Street
Springfield, Illinois 62761

Re: Chicago Public Schools - 2013 Three-Year Reinspections

Dear Mr. Cook:

Carnow, Conibear and Associates, Managing Environmental Consultant (MEC), conducted the Three-Year Reinspections and performed management plan updates for the Chicago Public Schools (CPS) facilities in Region 3,4,5 Elementary Schools. Please update your records with the following information.

School District: 299 Unit: 66381 Region: 02 IDPH ID: 14-016-2990-423X

School: Chicago International Charter - Wrightwood Building ID: 3180

Address: 8130 S. California Ave.

Chicago, IL, 60652

Building Contact: Contact Phone:

Current Building Owners: Chicago Public Schools

Review Date: 8/13/2013

Inspector: Douglas McCormick Inspector IDPH License: 100-08904
Management Planner: Todd Huffer Management Planner IDPH License: 100-09870

If you have any questions or comments, please contact us at (312) 762-2900

Sincerely,
Carnow, Conibear and Associates



Todd Huffer
100-09870

Environmental Notification to Occupants

To: Faculty, Staff and Parents
From: Chicago Public Schools
Date: August 13, 2013

RE: Chicago International Charter - Wrightwood, Unit 66381
8130 S. California Ave.
Chicago, IL, 60652

Dear Faculty, Staff and Parents,

This letter is to notify you that the 2013 asbestos three year re-inspection has been completed at Chicago International Charter - Wrightwood , following the Federal Asbestos Hazard Emergency Response Act (AHERA), 40 CFR Part 763, Subpart E and is available for your review at the main office of the school.

Although asbestos-containing materials have been identified at Chicago International Charter - Wrightwood, there is no reason to believe that any threat to the health of students or staff exists at this time. CPS will continue to carefully monitor the condition of asbestos-containing materials and if conditions warrant, all appropriate steps will be taken to maintain the health and safety of all building occupants.

If you have any questions regarding this matter or require additional information, please feel free to contact Ms. Lynn Crivello, the designated Local Education Authority's Designated Person at (773) 553-3113 .

Table of Contents

- I. School and Inspection Information
- II. Executive Summary
- III. Methodology
- IV. Abatement History
- V. Reassessments and Recommendations
- VI. Conclusions

Table I: Inspector's Reinspection Findings

Table II: Management Planner's Review

APPENDICES:

- Appendix A: Assessment Sheets, Drawings and Photos
- Appendix B: Inspector and Management Planner Licenses
- Appendix C: Laboratory Accreditations
- Appendix D: Laboratory Results
- Appendix E: Chain of Custody Forms

SCHOOL AND INSPECTION INFORMATION

1. School Information

School: Chicago International Charter - Wrightwood Unit: 66381 Region: 02
Address: 8130 S. California Ave. Chicago, IL, 60652
IDPH ID: 14-016-2990-423X Building ID: 3180
Contact: Phone:

2. Description of Facility

Original Construction: Additional Construction:
Total Square Footage: No of Floors:
Current Occupancy: 731

3. LEA Designated Person

Contact: Ms. Lynn Crivello Phone: (773) 553-3113
Address: 125 South Clark Street, 17th Floor
Chicago, IL 60603

4. Managing Environmental Consultant

MEC: Carnow, Conibear and Associates
Contact: Dan Juneau
Address 600 West Van Buren St., Ste 500
Phone: (312) 762-2900 Fax: (312) 782-5145

5. Inspector

Inspector Name: Douglas McCormick

Inspector IDPH license # 100-08904

Signature:
Date: 8/13/2013

6. Management Planner

Management Planner Name: Todd Huffer

Management Planner IDPH license # 100-09870

Signature: 
Date: 8/13/2013

7. Review Date: 8/13/2013

8. LEA Designated Person's Acknowledgement

The reinspection report and recommendations have been received by me and appropriate action will be taken by the School District.

Signature: 

Date: 8/13/2013

Name: Ms. Lynn Crivello

II. EXECUTIVE SUMMARY

Carnow, Conibear and Associates was retained by the Chicago Public Schools (CPS) to perform a three-year asbestos reinspection of the Chicago International Charter - Wrightwood. This inspection was conducted in accordance with the United States Environmental Protection Agency (USEPA) Asbestos Hazard Emergency Response Act (AHERA) part 763.92 (b), and the ongoing Operations and Maintenance Program (O&M) originally designed in the School's Asbestos Management Plan. The purpose of this three-year reinspection is to record any condition changes in the asbestos-containing building material (ACBM) in the school since the previous three-year reinspection and the six-month periodic surveillance, to identify, assess, and include any Homogeneous Areas (HA) not identified in the Management Plan, and to recommend an appropriate response action to manage asbestos.

The inspector conducted a three-year reinspection of this facility under Illinois Department of Public Health (IDPH) school reinspection requirements and AHERA, sections 763.85 and 763.88. The main building and each addition to the main building, if constructed at different dates, were inspected separately. Laboratory accreditations are included in Appendix C, laboratory results are included in Appendix D, and chain of custody forms are included in Appendix E.

Note: During previous inspections, some of the HA(s) were identified together as 9" x 9" floor tile (FT), mastics assoc. with 9" x 9" FT, 12" x 12" FT, mastics assoc. with 12" x 12" FT, pipe insulation, etc. Some of these HA(s) have been re-identified by areas that are uniform in color, texture, construction date, application date, and general appearance.

The inspector has determined the following:

A. The following HAs have changed assessment categories for Building 3180:

B. The following new homogenous areas have been identified for Building 3180:

21	12" x 12" Beige Floor Tile w/Gray Streaks
22	12" x 12" Beige Floor Tile w/Gray Streaks Mastic
23	12" x 12" Tan Floor Tile w/Brown Streaks
24	12" x 12" Tan Floor Tile w/Brown Streaks Mastic
25	1' x 1' White Ceiling Tile w/Deep Fissures
26	12" x 12" Dark Gray Floor Tile w/Black Streaks
27	12" x 12" Dark Gray Floor Tile w/Black Streaks Mastic

C. This reinspection covered only physically accessible and visible areas and materials that were identified in the LEA's management plan. The following materials were concealed and/or contained in areas that were inaccessible for sampling and have been classified as Assumed:

12	2x4 Ceiling Tile
13	Red and Beige Terrazzo
14	Carpet Mastic over Tile
15	12 x 12 Brown Floor Tile
16	12 x 12 Brown Floor Tile Mastic
17	12 x 12 Beige Floor Tile
18	12 x 12 Red Floor Tile
19	9 x 9 Green Floor Tile Mastic
20	9" x 9" Tan Floor Tile Mastic
21	12" x 12" Beige Floor Tile w/Gray Streaks
22	12" x 12" Beige Floor Tile w/Gray Streaks Mastic
23	12" x 12" Tan Floor Tile w/Brown Streaks
24	12" x 12" Tan Floor Tile w/Brown Streaks Mastic
25	1' x 1' White Ceiling Tile w/Deep Fissures
26	12" x 12" Dark Gray Floor Tile w/Black Streaks
27	12" x 12" Dark Gray Floor Tile w/Black Streaks Mastic

The following areas were deemed to be inaccessible:

01	Pipe Insulation
02	Pipe Joint Insulation
10	Boiler Insulation (ABATED 2004)
14	Carpet Mastic over Tile
19	9 x 9 Green Floor Tile Mastic

Materials were also listed as "assumed" if they were in good condition and sampling was not conducted to avoid damage.

This reinspection was conducted by Douglas McCormick, IDPH License # 100-08904. The Management Plan was updated by Todd Huffer, IDPH License # 100-09870. Inspector and Management Planner Licenses are included in Appendix B.

III. METHODOLOGY

Tasks performed on-site included the following:

1. Review current management plan, identify HA(s) and extract appropriate information.
2. Examine and verify abatement records.
3. Touch and visually and physically reinspect and reassess the condition of all friable known or assumed ACBM.
4. Touch and visually and physically reinspect all non-friable known or assumed ACBM to determine whether these materials have become friable since the last inspection or periodic surveillance.
5. Identify any condition changes that may affect Hazard Ranking of known ACBM or Assumed ACBM, as well as any HA(s) that have become friable since the last reinspection.
6. Collect bulk samples from each newly discovered friable HA or previously assumed and submit for laboratory analysis.
7. Tabulate reinspection findings and submit for management planner review and recommendations with appropriate response actions based on the AHERA Damage Category of the ACBM.
8. Submit reinspection findings and management planner recommendations to the LEA within thirty (30) days for inclusion into the management plan.

IV. ABATEMENT HISTORY

The information collected from the existing management plan and inspection report(s) and from interviews with the school official revealed that the following asbestos abatement was conducted at the school since the previous Three year Reinspection.

Abatement Dates:

V. REASSESSMENTS AND RECOMMENDATIONS

The reassessments and recommendations are summarized in Tables I and II on the following pages. Detailed Hazard Assessment Sheets and Drawings and Photos (if applicable) are included in Appendix A.

VI. CONCLUSIONS

The Chicago International Charter - Wrightwood Building 3180 Three-Year reinspection has been completed and response actions have been recommended for both friable and non-friable materials. A timely execution of the response actions recommended will enable the LEA and the Designated Person(s) to effectively manage the existing ACBM.

This three-year reinspection report should be inspected in the current Management plan at the CPS Central Office, and one (1) copy should be kept at the school for use when planning any renovation and/or demolition activities in areas where ACBM has been identified. Also, periodic surveillance documentation and any summary reports from any response actions that are executed at the school should be used to update the Management Plan.

Table I
Inspector's Reinspection Findings

Chicago Public Schools

School Chicago International Charter - Wrightwood Unit 66381 Building ID 3180
Address 8130 S. California Ave. Region 02

ASBESTOS REINSPECTION FINDINGS AND RECOMMENDATIONS Inspector's Reinspection Findings Table 1

Managing Environmental Consultant (MEC) Carnow, Conibear and Associates

600 West Van Buren St., Ste 500
Phone: (312) 762-2900 Fax: (312) 782-5145

Inspector's Comments are Summarized at the End of the Report

HA No	Material Description	Material Quantity	Material Units	Material Location	Asbestos Type	Material Category	Friable	Damage Type	Damage Quantity	Damage Units	Change in Assessment Category	Damage Category	Damage Reason	Disturbance Potential
01	Pipe Insulation	1,350	LF	Cafeteria, Basement/Pipe Chases	CHR	TSI	Y	NONE	0		No	ACBM with the potential for damage		MODERATE
02	Pipe Joint Insulation	3,150	LF	Cafeteria, Basement/Pipe Chases	CHR	TSI	Y	NONE	0		No	ACBM with the potential for damage		MODERATE
03	12"x12" Beige Floor Tile Mastic	9,000	SF	Kitchen/Basement	CHR	MISC	N	NONE	0		No	ACBM with the potential for damage		MODERATE
04	12"x12" Red Floor Tile Mastic	968	SF	Science/Storage	CHR	MISC	N	NONE	0		No	ACBM with the potential for damage		MODERATE
05	12"x12" Ceiling Tile Glue	18,000	SF	Corridors/Basement, Rooms 1 - 8, 25-27, 30-32	CHR	MISC	N	NONE	0		No	ACBM with the potential for damage		MODERATE
06	9"x9" Green Floor Tile	2,400	SF	Rooms 19, 20, 21, 29, 31, 33, 35, 37	CHR	MISC	N	NONE	0		No	ACBM with the potential for damage		MODERATE
07	9"x9" Tan Floor Tile	3,120	SF	Rooms 19, 20, 21, 28, 31, 32, 33, 35, 37	CHR	MISC	N	NONE	0		No	ACBM with the potential for damage		MODERATE
08	Spray-on Ceiling	1,464	SF	Art Room	CHR	SURFACE	N	NONE	0		No	ACBM with the potential for damage		MODERATE
09	9"x9" Gray Floor Tile	780	SF	Room 11	CHR	MISC	N	NONE	0		No	ACBM with the potential for damage		MODERATE
10	Boiler Insulation (ABATED 2004)			Boiler Room	CHR	TSI	Y	NONE			No	ACBM with the potential for damage		MODERATE
11	12"x12" Floor Tile	100	SF	1st Floor Storage Room	CHR	MISC	N	NONE	0		No	ACBM with the potential for damage		MODERATE
12	2x4 Ceiling Tile	4,220	SF	Bldg A - 1st and 2nd Floor Hallways	ASSUMED	MISC	Y	NONE	0		No	ACBM with the potential for damage		MODERATE
13	Red and Beige Terrazzo	15,000	SF	Buildings A and B - Hallways, Stairwells, Bathroom	ASSUMED	MISC	N	NONE	0		No	ACBM with the potential for damage		MODERATE
14	Carpet Mastic over Tile	3,500	SF	Rooms 11, 17-18, 21, 25-32, and Library Offices	ASSUMED	MISC	N	NONE	0		No	ACBM with the potential for damage		MODERATE
15	12 x 12 Brown Floor Tile	2,000	SF	Rooms 12, 19, 20 and 23	ASSUMED	MISC	N	NONE	0		No	ACBM with the potential for damage		MODERATE
16	12 x 12 Brown Floor Tile Mastic	2,000	SF	Rooms 12, 19, 20 and 23	ASSUMED	MISC	N	NONE	0		No	ACBM with the potential for damage		MODERATE
17	12 x 12 Beige Floor Tile	9,000	SF	Kitchen/Basement	ASSUMED	MISC	N	NONE	0		No	ACBM with the potential for damage		MODERATE
18	12 x 12 Red Floor Tile	968	SF	Science / Storage	ASSUMED	MISC	N	NONE	0		No	ACBM with the potential for damage		MODERATE
19	9 x 9 Green Floor Tile Mastic	3,900	SF	Rooms 4, 8, 19, 20-21, 28, 31, 33, 35,	ASSUMED	MISC	N	NONE	0		No	ACBM with the potential for damage		MODERATE

Chicago Public Schools

School Chicago International Charter - Wrightwood Unit 66381 Building ID 3180
 Address 8130 S. California Ave. Region 02

ASBESTOS REINSPECTION FINDINGS AND RECOMMENDATIONS Inspector's Reinspection Findings Table 1

Managing Environmental Consultant (MEC) Carnow, Conibear and Associates
 600 West Van Buren St., Ste 500
 Phone: (312) 762-2900 Fax: (312) 782-5145

Inspector's Comments are Summarized at the End of the Report

HA No	Material Description	Material Quantity	Material Units	Material Location	Asbestos Type	Material Category	Friable	Damage Type	Damage Quantity	Damage Units	Change in Assessment Category	Damage Category	Damage Reason	Disturbance Potential
20	9" x 9" Tan Floor Tile Mastic	3,900	SF	37 Rooms 4, 8, 19-21, 28, 31, 33, 35 & 37	ASSUMED	MISC	N	NONE	0		No	ACBM with the potential for damage		MODERATE
21	12" x 12" Beige Floor Tile w/Gray Streaks	3,600	SF	Rooms 10, 14, 17, 22 & 24	ASSUMED	MISC	N	NONE			No	ACBM with the potential for damage		MODERATE
22	12" x 12" Beige Floor Tile w/Gray Streaks Mastic	3,600	SF	Rooms 10, 14, 17, 22 & 24	ASSUMED	MISC	N	NONE			No	ACBM with the potential for damage		MODERATE
23	12" x 12" Tan Floor Tile w/Brown Streaks	5,488	SF	Rooms 2, 4, 6, 7, 8 & 15	ASSUMED	MISC	N	NONE	0		No	ACBM with the potential for damage		MODERATE
24	12" x 12" Tan Floor Tile w/Brown Streaks Mastic	5,488	SF	Rooms 2, 4, 6, 7, 8 & 15	ASSUMED	MISC	N	NONE	0		No	ACBM with the potential for damage		MODERATE
25	1' x 1' White Ceiling Tile w/Deep Fissures	11,000	SF	Rooms 1-8, 25-27 & 50-52	ASSUMED	MISC	Y	NONE	0		No	ACBM with the potential for damage		MODERATE
26	12" x 12" Dark Gray Floor Tile w/Black Streaks	5,488	SF	Rooms 1, 3, 5, 9, 13, 16 & 26-27	ASSUMED	MISC	N	NONE	0		No	ACBM with the potential for damage		MODERATE
27	12" x 12" Dark Gray Floor Tile w/Black Streaks Mastic	5,488	SF	Rooms 1, 3, 5, 9, 13, 16 & 26-27	ASSUMED	MISC	N	NONE	0		No	ACBM with the potential for damage		MODERATE

Chicago Public Schools

School Chicago International Charter - Wrightwood Unit 66381 Building ID 3180
Address 8130 S. California Ave. Region 02

ASBESTOS REINSPECTION FINDINGS AND RECOMMENDATIONS Inspector's Reinspection Findings Table 1

Managing Environmental Consultant (MEC) Carnow, Conibear and Associates

600 West Van Buren St., Ste 500
Phone: (312) 762-2900 Fax: (312) 782-5145

Inspector's Comments are Summarized at the End of the Report

Reinspection Date **8/13/2013**
Inspector Name **Douglas McCormick**
100-08904 **5/15/2013**
Inspector's IDPH License Number / Expiration Date

Inspector's Comments

HA Number:	Inspector Comments:
01	
02	
03	
04	
05	
06	
07	
08	
09	
10	
11	
12	
13	
14	
15	
16	
17	
18	
19	
20	
21	
22	
23	
24	

Chicago Public Schools

School Chicago International Charter - Wrightwood Unit 66381 Building ID 3180
Address 8130 S. California Ave. Region 02

ASBESTOS REINSPECTION FINDINGS AND RECOMMENDATIONS Inspector's Reinspection Findings Table 1

Managing Environmental Consultant (MEC) Carnow, Conibear and Associates
600 West Van Buren St., Ste 500
Phone: (312) 762-2900 Fax: (312) 782-5145

Inspector's Comments are Summarized at the End of the Report

HA Number:	Inspector Comments:
25	
26	
27	

Table II

Management Planner's Review

Chicago Public Schools

School Chicago International Charter - Wrightwood
 Address 8130 S. California Ave.

Unit 66381
 Chicago, IL, 60652

Building ID 3180
 Region 02

ASBESTOS REINSPECTION FINDINGS AND RECOMMENDATIONS

Management Planner's Review Table II

Managing Environmental Consultant (MEC) Carnow, Conibear and Associates

600 West Van Buren St., Ste 500

Phone: (312) 762-2900

Fax: (312) 762-5145

Management Planner's Comments Summarized at the End of the Report

HA Num	Material Description	Material Quantity	Material Units	Material Location	Asbestos Type	Material Category	Friable	Damage Quantity	Damage Units	Damage Category	Response
01	Pipe Insulation	1,350	LF	Catereria, Basement/Pipe Chases	Chrysotile	TSI	Yes	0	LF	6 ACBM with the potential for damage	Operations and Maintenance
02	Pipe Joint Insulation	3,150	LF	Catereria, Basement/Pipe Chases	Chrysotile	TSI	Yes	0	LF	6 ACBM with the potential for damage	Operations and Maintenance
03	12"x12" Beige Floor Tile Mastic	9,000	SF	Kitchen/Basement	Chrysotile	MISC	No	0	SF	6 ACBM with the potential for damage	Operations and Maintenance
04	12"x12" Red Floor Tile Mastic	968	SF	Science/Storage	Chrysotile	MISC	No	0	SF	6 ACBM with the potential for damage	Operations and Maintenance
05	12"x12" Ceiling Tile Glue	18,000	SF	Corridors/Basement, Rooms 1 - 8, 25-27, 30-32	Chrysotile	MISC	No	0	SF	6 ACBM with the potential for damage	Operations and Maintenance
06	9"x9" Green Floor Tile	2,400	SF	Rooms 19, 20, 21, 29, 31, 33, 35, 37	Chrysotile	MISC	No	0	SF	6 ACBM with the potential for damage	Operations and Maintenance
07	9"x9" Tan Floor Tile	3,120	SF	Rooms 19, 20, 21, 28, 31, 32, 33, 35, 37	Chrysotile	MISC	No	0	SF	6 ACBM with the potential for damage	Operations and Maintenance
08	Spray-on Ceiling	1,464	SF	Art Room	Chrysotile	SURFACE	No	0	SF	6 ACBM with the potential for damage	Operations and Maintenance
09	9"x9" Gray Floor Tile	780	SF	Room 11	Chrysotile	MISC	No	0	SF	6 ACBM with the potential for damage	Operations and Maintenance
10	Boiler Insulation (ABATED 2004)			Boiler Room	Chrysotile	TSI	Yes				
11	12"x12" Floor Tile	100	SF	1st Floor Storage Room	Chrysotile	MISC	No	0	SF	6 ACBM with the potential for damage	Operations and Maintenance
12	2x4 Ceiling Tile	4,220	SF	Bldg A - 1st and 2nd Floor Hallways	Assumed	MISC	Yes	0	SF	6 ACBM with the potential for damage	Operations and Maintenance
13	Red and Beige Terrazzo	15,000	SF	Buildings A and B - Hallways, Stairwells, Bathroom	Assumed	MISC	No	0	SF	6 ACBM with the potential for damage	Operations and Maintenance
14	Carpet Mastic over Tile	3,500	SF	Rooms 11, 17-18, 21, 25-32, and Library Offices	Assumed	MISC	No	0	SF	6 ACBM with the potential for damage	Operations and Maintenance
15	12 x 12 Brown Floor Tile	2,000	SF	Rooms 12, 19, 20 and 23	Assumed	MISC	No	0	SF	6 ACBM with the potential for damage	Operations and Maintenance
16	12 x 12 Brown Floor Tile Mastic	2,000	SF	Rooms 12, 19, 20 and 23	Assumed	MISC	No	0	SF	6 ACBM with the potential for damage	Operations and Maintenance
17	12 x 12 Beige Floor Tile	9,000	SF	Kitchen/Basement	Assumed	MISC	No	0	SF	6 ACBM with the potential for damage	Operations and Maintenance
18	12 x 12 Red Floor Tile	968	SF	Science / Storage	Assumed	MISC	No	0	SF	6 ACBM with the potential for damage	Operations and Maintenance
19	9 x 9 Green Floor Tile Mastic	3,900	SF	Rooms 4, 8, 19, 20-21, 28, 31, 33, 35, 37	Assumed	MISC	No	0	SF	6 ACBM with the potential for damage	Operations and Maintenance
20	9" x 9" Tan Floor Tile Mastic	3,900	SF	Rooms 4, 8, 19-21, 28, 31, 33, 35 & 37	Assumed	MISC	No	0	SF	6 ACBM with the potential for damage	Operations and Maintenance
21	12" x 12" Beige Floor Tile w/Gray Streaks	3,600	SF	Rooms 10, 14, 17, 22 & 24	Assumed	MISC	No	0	SF	6 ACBM with the potential for damage	Operations and Maintenance
22	12" x 12" Beige Floor Tile w/Gray Streaks Mastic	3,600	SF	Rooms 10, 14, 17, 22 & 24	Assumed	MISC	No	0	SF	6 ACBM with the potential for damage	Operations and Maintenance
23	12" x 12" Tan Floor Tile w/Brown Streaks	5,488	SF	Rooms 2, 4, 6, 7, 8 & 15	Assumed	MISC	No	0	SF	6 ACBM with the potential for damage	Operations and Maintenance
24	12" x 12" Tan Floor Tile w/Brown Streaks Mastic	5,488	SF	Rooms 2, 4, 6, 7, 8 & 15	Assumed	MISC	No	0	SF	6 ACBM with the potential for damage	Operations and Maintenance
25	1" x 1" White Ceiling Tile w/Deep Fissures	11,000	SF	Rooms 1-8, 25-27 & 30-32	Assumed	MISC	Yes	0	SF	6 ACBM with the potential for damage	Operations and Maintenance
26	12" x 12" Dark Gray Floor Tile w/Black Streaks	5,488	SF	Rooms 1, 3, 5, 9, 13, 16 & 26-27	Assumed	MISC	No	0	SF	6 ACBM with the potential for damage	Operations and Maintenance
27	12" x 12" Dark Gray Floor Tile w/Black Streaks Mastic	5,488	SF	Rooms 1, 3, 5, 9, 13, 16 & 26-27	Assumed	MISC	No	0	SF	6 ACBM with the potential for damage	Operations and Maintenance

Chicago Public Schools

School Chicago International
Charter - Wrightwood
Address 8130 S. California Ave.

Unit 66381
Chicago, IL, 60652

Building ID 3180
Region 02

ASBESTOS REINSPECTION FINDINGS AND RECOMMENDATIONS

Management Planner's Review Table II

Managing Environmental Consultant (MEC) Carnow, Conibear and Associates
600 West Van Buren St., Ste 500

Phone: (312) 762-2900 **Fax:** (312) 762-5145

Management Planner's Comments Summarized at the End of the Report

Review Date	8/13/2013
Manager Planner Name	Todd Huffer
100-09870	5/15/2013
Manager IDPH License No/Expiration	

HA Number	Management Comments
01	
02	
03	
04	
05	
06	

Chicago Public Schools

School Chicago International
Charter - Wrightwood
Address 8130 S. California Ave.

Unit 66381
Chicago, IL, 60652

Building ID 3180
Region 02

ASBESTOS REINSPECTION FINDINGS AND RECOMMENDATIONS

Management Planner's Review Table II

Managing Environmental Consultant (MEC) Carnow, Conibear and Associates
600 West Van Buren St., Ste 500

Phone: (312) 762-2900

Fax: (312) 762-5145

Management Planner's Comments Summarized at the End of the Report

HA Number	Management Comments
07	
08	
09	
10	Abated 2004
11	
12	
13	
14	
15	
16	
17	
18	
19	
20	
21	
22	
23	
24	
25	
26	
27	

Chicago Public Schools

Carnow, Conibear and Associates

2013 AHERA REINSPECTION

Inspector Assessment Form (REASSESSMENT)

LEA NAME: **Chicago Public Schools** UNIT NUMBER: **66381** BUIDLING ID: **3180**
CITY/STATE: **Chicago, Illinois** AHERA INSPECTOR: **Douglas McCormick**
SCHOOL NAME: **Chicago International Charter - Wrightwood** INSPECTION DATE: **8/13/2013**
ADDRESS: **8130 S. California Ave.** IDPH LICENSE NO: **100-08904**

INFORMATION FROM PREVIOUS INSPECTION

HOMOGENEOUS AREA: **01**
MATERIAL DESCRIPTION: **Pipe Insulation**
HISTORICAL AHERA DAMAGE CATEGORY **6 ACBM with the potential for damage**
HISTORICAL DAMAGE REASON:
HISTORICAL RESPONSE ACTION: **Operations and Maintenance**
ASBESTOS TYPE: **Chrysotile** FRIABLE: **Yes**

RESULTS OF REINSPECTION AND REASSESSMENT

This homogeneous area was reinspected and reassessed in accordance with Section 763.85 and 763.88 of AHERA and it's condition HAS NOT CHANGED when compared to the conditions of the last AHERA reinspection.

The current AHERA DAMAGE CATEGORY is determined to be **6. ACBM with the potential for damage**

DAMAGE REASON:

DISTURBANCE POTENTIAL: **MODERATE**

MATERIAL LOCATION: **Cafeteria, Basement/Pipe Chases**

MATERIAL QUANTITY: **1350** MATERIAL UNITS: **LF**

DAMAGE QUANTITY: DAMAGE UNITS: **LF**

COMMENTS:

Inspector's Signature: _____ Date: 08/13/2013

Chicago Public Schools

Carnow, Conibear and Associates

2013 AHERA REINSPECTION

Management Planner Review Form

LEA NAME: **Chicago Public Schools** UNIT NUMBER: **66381** BUIDLING ID: **3180**
CITY/STATE: **Chicago, Illinois** MANAGEMENT PLANNER: **Todd Huffer**
SCHOOL NAME: **Chicago International Charter - Wrightwood** REVIEW DATE: **8/13/2013**
ADDRESS: **8130 S. California Ave.** IDPH LICENSE NO: **100-08904**

HOMOGENEOUS AREA: **01**
MATERIAL DESCRIPTION: **Pipe Insulation**
MATERIAL LOCATION: **Cafeteria, Basement/Pipe Chases**
MATERIAL QUANTITY: **1350** MATERIAL UNITS: **LF**
DAMAGE QUANTITY: **0** DAMAGE UNITS: **LF**

In accordance with Sections 763.88 and 763.90 of the Asbestos Hazard Emergency Response Act (AHERA) the LEA must select a management planner to review the results of the inspection and assessment and recommend appropriate response actions. The original inspection of the above identified homogeneous area has been reviewed in accordance with Sections 763.88 and 763.90 with the following recommendations.

The RESPONSE ACTION recommendation is:

Operations and Maintenance

Comments:

Management Planner's Signature: _____



Date: **08/13/2013**

Chicago Public Schools

Carnow, Conibear and Associates

2013 AHERA REINSPECTION

Inspector Assessment Form (REASSESSMENT)

LEA NAME: **Chicago Public Schools** UNIT NUMBER: **66381** BUIDLING ID: **3180**
CITY/STATE: **Chicago, Illinois** AHERA INSPECTOR: **Douglas McCormick**
SCHOOL NAME: **Chicago International Charter - Wrightwood** INSPECTION DATE: **8/13/2013**
ADDRESS: **8130 S. California Ave.** IDPH LICENSE NO: **100-08904**

INFORMATION FROM PREVIOUS INSPECTION

HOMOGENEOUS AREA: **02**
MATERIAL DESCRIPTION: **Pipe Joint Insulation**
HISTORICAL AHERA DAMAGE CATEGORY **6 ACBM with the potential for damage**
HISTORICAL DAMAGE REASON:
HISTORICAL RESPONSE ACTION: **Operations and Maintenance**
ASBESTOS TYPE: **Chrysotile** FRIABLE: **Yes**

RESULTS OF REINSPECTION AND REASSESSMENT

This homogeneous area was reinspected and reassessed in accordance with Section 763.85 and 763.88 of AHERA and it's condition HAS NOT CHANGED when compared to the conditions of the last AHERA reinspection.

The current AHERA DAMAGE CATEGORY is determined to be **6. ACBM with the potential for damage**

DAMAGE REASON:

DISTURBANCE POTENTIAL: **MODERATE**

MATERIAL LOCATION: **Cafeteria, Basement/Pipe Chases**

MATERIAL QUANTITY: **3150** MATERIAL UNITS: **LF**

DAMAGE QUANTITY: DAMAGE UNITS: **LF**

COMMENTS:

Inspector's Signature: _____ Date: **08/13/2013**

Chicago Public Schools

Carnow, Conibear and Associates

2013 AHERA REINSPECTION

Management Planner Review Form

LEA NAME: **Chicago Public Schools** UNIT NUMBER: **66381** BUIDLING ID: **3180**
CITY/STATE: **Chicago, Illinois** MANAGEMENT PLANNER: **Todd Huffer**
SCHOOL NAME: **Chicago International Charter - Wrightwood** REVIEW DATE: **8/13/2013**
ADDRESS: **8130 S. California Ave.** IDPH LICENSE NO: **100-08904**

HOMOGENEOUS AREA: **02**
MATERIAL DESCRIPTION: **Pipe Joint Insulation**
MATERIAL LOCATION: **Cafeteria, Basement/Pipe Chases**
MATERIAL QUANTITY: **3150** MATERIAL UNITS: **LF**
DAMAGE QUANTITY: **0** DAMAGE UNITS: **LF**

In accordance with Sections 763.88 and 763.90 of the Asbestos Hazard Emergency Response Act (AHERA) the LEA must select a management planner to review the results of the inspection and assessment and recommend appropriate response actions. The original inspection of the above identified homogeneous area has been reviewed in accordance with Sections 763.88 and 763.90 with the following recommendations.

The RESPONSE ACTION recommendation is:

Operations and Maintenance

Comments:

Management Planner's Signature: _____



Date: **08/13/2013**

Chicago Public Schools

Carnow, Conibear and Associates

2013 AHERA REINSPECTION

Inspector Assessment Form (REASSESSMENT)

LEA NAME: **Chicago Public Schools** UNIT NUMBER: **66381** BUIDLING ID: **3180**
CITY/STATE: **Chicago, Illinois** AHERA INSPECTOR: **Douglas McCormick**
SCHOOL NAME: **Chicago International Charter - Wrightwood** INSPECTION DATE: **8/13/2013**
ADDRESS: **8130 S. California Ave.** IDPH LICENSE NO: **100-08904**

INFORMATION FROM PREVIOUS INSPECTION

HOMOGENEOUS AREA: **03**
MATERIAL DESCRIPTION: **12"x12" Beige Floor Tile Mastic**
HISTORICAL AHERA DAMAGE CATEGORY **6 ACBM with the potential for damage**
HISTORICAL DAMAGE REASON:
HISTORICAL RESPONSE ACTION: **Operations and Maintenance**
ASBESTOS TYPE: **Chrysotile** FRIABLE: **No**

RESULTS OF REINSPECTION AND REASSESSMENT

This homogeneous area was reinspected and reassessed in accordance with Section 763.85 and 763.88 of AHERA and it's condition HAS NOT CHANGED when compared to the conditions of the last AHERA reinspection.

The current AHERA DAMAGE CATEGORY is determined to be **6. ACBM with the potential for damage**

DAMAGE REASON:

DISTURBANCE POTENTIAL: **MODERATE**

MATERIAL LOCATION: **Kitchen/Basement**

MATERIAL QUANTITY: **9000**

MATERIAL UNITS: **SF**

DAMAGE QUANTITY:

DAMAGE UNITS: **SF**

COMMENTS:

Inspector's Signature: _____

Date: 08/13/2013

Chicago Public Schools

Carnow, Conibear and Associates

2013 AHERA REINSPECTION

Management Planner Review Form

LEA NAME: **Chicago Public Schools** UNIT NUMBER: **66381** BUIDLING ID: **3180**
CITY/STATE: **Chicago, Illinois** MANAGEMENT PLANNER: **Todd Huffer**
SCHOOL NAME: **Chicago International Charter - Wrightwood** REVIEW DATE: **8/13/2013**
ADDRESS: **8130 S. California Ave.** IDPH LICENSE NO: **100-08904**

HOMOGENEOUS AREA: **03**
MATERIAL DESCRIPTION: **12"x12" Beige Floor Tile Mastic**
MATERIAL LOCATION: **Kitchen/Basement**
MATERIAL QUANTITY: **9000** MATERIAL UNITS: **SF**
DAMAGE QUANTITY: **0** DAMAGE UNITS: **SF**

In accordance with Sections 763.88 and 763.90 of the Asbestos Hazard Emergency Response Act (AHERA) the LEA must select a management planner to review the results of the inspection and assessment and recommend appropriate response actions. The original inspection of the above identified homogeneous area has been reviewed in accordance with Sections 763.88 and 763.90 with the following recommendations.

The RESPONSE ACTION recommendation is:

Operations and Maintenance

Comments:

Management Planner's Signature: _____



Date: **08/13/2013**

Chicago Public Schools

Carnow, Conibear and Associates

2013 AHERA REINSPECTION

Inspector Assessment Form (REASSESSMENT)

LEA NAME: **Chicago Public Schools** UNIT NUMBER: **66381** BUIDLING ID: **3180**
CITY/STATE: **Chicago, Illinois** AHERA INSPECTOR: **Douglas McCormick**
SCHOOL NAME: **Chicago International Charter - Wrightwood** INSPECTION DATE: **8/13/2013**
ADDRESS: **8130 S. California Ave.** IDPH LICENSE NO: **100-08904**

INFORMATION FROM PREVIOUS INSPECTION

HOMOGENEOUS AREA: **04**
MATERIAL DESCRIPTION: **12"x12" Red Floor Tile Mastic**
HISTORICAL AHERA DAMAGE CATEGORY **6 ACBM with the potential for damage**
HISTORICAL DAMAGE REASON:
HISTORICAL RESPONSE ACTION: **Operations and Maintenance**
ASBESTOS TYPE: **Chrysotile** FRIABLE: **No**

RESULTS OF REINSPECTION AND REASSESSMENT

This homogeneous area was reinspected and reassessed in accordance with Section 763.85 and 763.88 of AHERA and it's condition HAS NOT CHANGED when compared to the conditions of the last AHERA reinspection.

The current AHERA DAMAGE CATEGORY is determined to be **6. ACBM with the potential for damage**

DAMAGE REASON:

DISTURBANCE POTENTIAL: **MODERATE**

MATERIAL LOCATION: **Science/Storage**

MATERIAL QUANTITY: **968**

MATERIAL UNITS: **SF**

DAMAGE QUANTITY:

DAMAGE UNITS: **SF**

COMMENTS:

Inspector's Signature: _____

Date: **08/13/2013**

Chicago Public Schools

Carnow, Conibear and Associates

2013 AHERA REINSPECTION

Management Planner Review Form

LEA NAME: **Chicago Public Schools** UNIT NUMBER: **66381** BUIDLING ID: **3180**
CITY/STATE: **Chicago, Illinois** MANAGEMENT PLANNER: **Todd Huffer**
SCHOOL NAME: **Chicago International Charter - Wrightwood** REVIEW DATE: **8/13/2013**
ADDRESS: **8130 S. California Ave.** IDPH LICENSE NO: **100-08904**

HOMOGENEOUS AREA: **04**
MATERIAL DESCRIPTION: **12"x12" Red Floor Tile Mastic**
MATERIAL LOCATION: **Science/Storage**
MATERIAL QUANTITY: **968** MATERIAL UNITS: **SF**
DAMAGE QUANTITY: **0** DAMAGE UNITS: **SF**

In accordance with Sections 763.88 and 763.90 of the Asbestos Hazard Emergency Response Act (AHERA) the LEA must select a management planner to review the results of the inspection and assessment and recommend appropriate response actions. The original inspection of the above identified homogeneous area has been reviewed in accordance with Sections 763.88 and 763.90 with the following recommendations.

The RESPONSE ACTION recommendation is:

Operations and Maintenance

Comments:

Management Planner's Signature: _____



Date: **08/13/2013**

Chicago Public Schools

Carnow, Conibear and Associates

2013 AHERA REINSPECTION

Inspector Assessment Form (REASSESSMENT)

LEA NAME: **Chicago Public Schools** UNIT NUMBER: **66381** BUIDLING ID: **3180**
CITY/STATE: **Chicago, Illinois** AHERA INSPECTOR: **Douglas McCormick**
SCHOOL NAME: **Chicago International Charter - Wrightwood** INSPECTION DATE: **8/13/2013**
ADDRESS: **8130 S. California Ave.** IDPH LICENSE NO: **100-08904**

INFORMATION FROM PREVIOUS INSPECTION

HOMOGENEOUS AREA: **05**
MATERIAL DESCRIPTION: **12"x12" Ceiling Tile Glue**
HISTORICAL AHERA DAMAGE CATEGORY **6 ACBM with the potential for damage**
HISTORICAL DAMAGE REASON:
HISTORICAL RESPONSE ACTION: **Operations and Maintenance**
ASBESTOS TYPE: **Chrysotile** FRIABLE: **No**

RESULTS OF REINSPECTION AND REASSESSMENT

This homogeneous area was reinspected and reassessed in accordance with Section 763.85 and 763.88 of AHERA and it's condition HAS NOT CHANGED when compared to the conditions of the last AHERA reinspection.

The current AHERA DAMAGE CATEGORY is determined to be **6. ACBM with the potential for damage**

DAMAGE REASON:

DISTURBANCE POTENTIAL: **MODERATE**

MATERIAL LOCATION: **Corridors/Basement, Rooms 1 - 8, 25-27, 30-32**

MATERIAL QUANTITY: **18000** MATERIAL UNITS: **SF**

DAMAGE QUANTITY: DAMAGE UNITS: **SF**

COMMENTS:

Inspector's Signature: _____ Date: **08/13/2013**

Chicago Public Schools

Carnow, Conibear and Associates

2013 AHERA REINSPECTION

Management Planner Review Form

LEA NAME: **Chicago Public Schools** UNIT NUMBER: **66381** BUIDLING ID: **3180**
CITY/STATE: **Chicago, Illinois** MANAGEMENT PLANNER: **Todd Huffer**
SCHOOL NAME: **Chicago International Charter - Wrightwood** REVIEW DATE: **8/13/2013**
ADDRESS: **8130 S. California Ave.** IDPH LICENSE NO: **100-08904**

HOMOGENEOUS AREA: **05**
MATERIAL DESCRIPTION: **12"x12" Ceiling Tile Glue**
MATERIAL LOCATION: **Corridors/Basement, Rooms 1 - 8, 25-27, 30-32**
MATERIAL QUANTITY: **18000** MATERIAL UNITS: **SF**
DAMAGE QUANTITY: **0** DAMAGE UNITS: **SF**

In accordance with Sections 763.88 and 763.90 of the Asbestos Hazard Emergency Response Act (AHERA) the LEA must select a management planner to review the results of the inspection and assessment and recommend appropriate response actions. The original inspection of the above identified homogeneous area has been reviewed in accordance with Sections 763.88 and 763.90 with the following recommendations.

The RESPONSE ACTION recommendation is:

Operations and Maintenance

Comments:

Management Planner's Signature: _____



Date: **08/13/2013**

Chicago Public Schools

Carnow, Conibear and Associates

2013 AHERA REINSPECTION

Inspector Assessment Form (REASSESSMENT)

LEA NAME: **Chicago Public Schools** UNIT NUMBER: **66381** BUIDLING ID: **3180**
CITY/STATE: **Chicago, Illinois** AHERA INSPECTOR: **Douglas McCormick**
SCHOOL NAME: **Chicago International Charter - Wrightwood** INSPECTION DATE: **8/13/2013**
ADDRESS: **8130 S. California Ave.** IDPH LICENSE NO: **100-08904**

INFORMATION FROM PREVIOUS INSPECTION

HOMOGENEOUS AREA: **06**
MATERIAL DESCRIPTION: **9"x9" Green Floor Tile**
HISTORICAL AHERA DAMAGE CATEGORY **6 ACBM with the potential for damage**
HISTORICAL DAMAGE REASON:
HISTORICAL RESPONSE ACTION: **Operations and Maintenance**
ASBESTOS TYPE: **Chrysotile** FRIABLE: **No**

RESULTS OF REINSPECTION AND REASSESSMENT

This homogeneous area was reinspected and reassessed in accordance with Section 763.85 and 763.88 of AHERA and it's condition HAS NOT CHANGED when compared to the conditions of the last AHERA reinspection.

The current AHERA DAMAGE CATEGORY is determined to be **6. ACBM with the potential for damage**

DAMAGE REASON:

DISTURBANCE POTENTIAL: **MODERATE**

MATERIAL LOCATION: **Rooms 19, 20, 21, 29, 31, 33, 35, 37**

MATERIAL QUANTITY: **2400**

MATERIAL UNITS: **SF**

DAMAGE QUANTITY:

DAMAGE UNITS: **SF**

COMMENTS:

Inspector's Signature: _____

Date: **08/13/2013**

Chicago Public Schools

Carnow, Conibear and Associates

2013 AHERA REINSPECTION

Management Planner Review Form

LEA NAME: **Chicago Public Schools** UNIT NUMBER: **66381** BUIDLING ID: **3180**
CITY/STATE: **Chicago, Illinois** MANAGEMENT PLANNER: **Todd Huffer**
SCHOOL NAME: **Chicago International Charter - Wrightwood** REVIEW DATE: **8/13/2013**
ADDRESS: **8130 S. California Ave.** IDPH LICENSE NO: **100-08904**

HOMOGENEOUS AREA: **06**
MATERIAL DESCRIPTION: **9"x9" Green Floor Tile**
MATERIAL LOCATION: **Rooms 19, 20, 21, 29, 31, 33, 35, 37**
MATERIAL QUANTITY: **2400** MATERIAL UNITS: **SF**
DAMAGE QUANTITY: **0** DAMAGE UNITS: **SF**

In accordance with Sections 763.88 and 763.90 of the Asbestos Hazard Emergency Response Act (AHERA) the LEA must select a management planner to review the results of the inspection and assessment and recommend appropriate response actions. The original inspection of the above identified homogeneous area has been reviewed in accordance with Sections 763.88 and 763.90 with the following recommendations.

The RESPONSE ACTION recommendation is:

Operations and Maintenance

Comments:

Management Planner's Signature: _____



Date: **08/13/2013**

Chicago Public Schools

Carnow, Conibear and Associates

2013 AHERA REINSPECTION

Inspector Assessment Form (REASSESSMENT)

LEA NAME: **Chicago Public Schools** UNIT NUMBER: **66381** BUIDLING ID: **3180**
CITY/STATE: **Chicago, Illinois** AHERA INSPECTOR: **Douglas McCormick**
SCHOOL NAME: **Chicago International Charter - Wrightwood** INSPECTION DATE: **8/13/2013**
ADDRESS: **8130 S. California Ave.** IDPH LICENSE NO: **100-08904**

INFORMATION FROM PREVIOUS INSPECTION

HOMOGENEOUS AREA: **07**
MATERIAL DESCRIPTION: **9"x9" Tan Floor Tile**
HISTORICAL AHERA DAMAGE CATEGORY **6 ACBM with the potential for damage**
HISTORICAL DAMAGE REASON:
HISTORICAL RESPONSE ACTION: **Operations and Maintenance**
ASBESTOS TYPE: **Chrysotile** FRIABLE: **No**

RESULTS OF REINSPECTION AND REASSESSMENT

This homogeneous area was reinspected and reassessed in accordance with Section 763.85 and 763.88 of AHERA and it's condition HAS NOT CHANGED when compared to the conditions of the last AHERA reinspection.

The current AHERA DAMAGE CATEGORY is determined to be **6. ACBM with the potential for damage**

DAMAGE REASON:

DISTURBANCE POTENTIAL: **MODERATE**

MATERIAL LOCATION: **Rooms 19, 20, 21, 28, 31, 32, 33, 35, 37**

MATERIAL QUANTITY: **3120**

MATERIAL UNITS: **SF**

DAMAGE QUANTITY:

DAMAGE UNITS: **SF**

COMMENTS:

Inspector's Signature: _____

Date: **08/13/2013**

Chicago Public Schools

Carnow, Conibear and Associates

2013 AHERA REINSPECTION

Management Planner Review Form

LEA NAME: **Chicago Public Schools** UNIT NUMBER: **66381** BUIDLING ID: **3180**
CITY/STATE: **Chicago, Illinois** MANAGEMENT PLANNER: **Todd Huffer**
SCHOOL NAME: **Chicago International Charter - Wrightwood** REVIEW DATE: **8/13/2013**
ADDRESS: **8130 S. California Ave.** IDPH LICENSE NO: **100-08904**

HOMOGENEOUS AREA: **07**
MATERIAL DESCRIPTION: **9"x9" Tan Floor Tile**
MATERIAL LOCATION: **Rooms 19, 20, 21, 28, 31, 32, 33, 35, 37**
MATERIAL QUANTITY: **3120** MATERIAL UNITS: **SF**
DAMAGE QUANTITY: **0** DAMAGE UNITS: **SF**

In accordance with Sections 763.88 and 763.90 of the Asbestos Hazard Emergency Response Act (AHERA) the LEA must select a management planner to review the results of the inspection and assessment and recommend appropriate response actions. The original inspection of the above identified homogeneous area has been reviewed in accordance with Sections 763.88 and 763.90 with the following recommendations.

The RESPONSE ACTION recommendation is:

Operations and Maintenance

Comments:

Management Planner's Signature: _____



Date: **08/13/2013**

Chicago Public Schools

Carnow, Conibear and Associates

2013 AHERA REINSPECTION

Inspector Assessment Form (REASSESSMENT)

LEA NAME: **Chicago Public Schools** UNIT NUMBER: **66381** BUIDLING ID: **3180**
CITY/STATE: **Chicago, Illinois** AHERA INSPECTOR: **Douglas McCormick**
SCHOOL NAME: **Chicago International Charter - Wrightwood** INSPECTION DATE: **8/13/2013**
ADDRESS: **8130 S. California Ave.** IDPH LICENSE NO: **100-08904**

INFORMATION FROM PREVIOUS INSPECTION

HOMOGENEOUS AREA: **08**
MATERIAL DESCRIPTION: **Spray-on Ceiling**
HISTORICAL AHERA DAMAGE CATEGORY **6 ACBM with the potential for damage**
HISTORICAL DAMAGE REASON:
HISTORICAL RESPONSE ACTION: **Operations and Maintenance**
ASBESTOS TYPE: **Chrysotile** FRIABLE: **No**

RESULTS OF REINSPECTION AND REASSESSMENT

This homogeneous area was reinspected and reassessed in accordance with Section 763.85 and 763.88 of AHERA and it's condition HAS NOT CHANGED when compared to the conditions of the last AHERA reinspection.

The current AHERA DAMAGE CATEGORY is determined to be **6. ACBM with the potential for damage**

DAMAGE REASON:

DISTURBANCE POTENTIAL: **MODERATE**

MATERIAL LOCATION: **Art Room**

MATERIAL QUANTITY: **1464**

MATERIAL UNITS: **SF**

DAMAGE QUANTITY:

DAMAGE UNITS: **SF**

COMMENTS:

Inspector's Signature: _____

Date: **08/13/2013**

Chicago Public Schools

Carnow, Conibear and Associates

2013 AHERA REINSPECTION

Management Planner Review Form

LEA NAME: **Chicago Public Schools** UNIT NUMBER: **66381** BUIDLING ID: **3180**
CITY/STATE: **Chicago, Illinois** MANAGEMENT PLANNER: **Todd Huffer**
SCHOOL NAME: **Chicago International Charter - Wrightwood** REVIEW DATE: **8/13/2013**
ADDRESS: **8130 S. California Ave.** IDPH LICENSE NO: **100-08904**

HOMOGENEOUS AREA: **08**
MATERIAL DESCRIPTION: **Spray-on Ceiling**
MATERIAL LOCATION: **Art Room**
MATERIAL QUANTITY: **1464** MATERIAL UNITS: **SF**
DAMAGE QUANTITY: **0** DAMAGE UNITS: **SF**

In accordance with Sections 763.88 and 763.90 of the Asbestos Hazard Emergency Response Act (AHERA) the LEA must select a management planner to review the results of the inspection and assessment and recommend appropriate response actions. The original inspection of the above identified homogeneous area has been reviewed in accordance with Sections 763.88 and 763.90 with the following recommendations.

The RESPONSE ACTION recommendation is:

Operations and Maintenance

Comments:

Management Planner's Signature: _____



Date: **08/13/2013**

Chicago Public Schools

Carnow, Conibear and Associates

2013 AHERA REINSPECTION

Inspector Assessment Form (REASSESSMENT)

LEA NAME: **Chicago Public Schools** UNIT NUMBER: **66381** BUIDLING ID: **3180**
CITY/STATE: **Chicago, Illinois** AHERA INSPECTOR: **Douglas McCormick**
SCHOOL NAME: **Chicago International Charter - Wrightwood** INSPECTION DATE: **8/13/2013**
ADDRESS: **8130 S. California Ave.** IDPH LICENSE NO: **100-08904**

INFORMATION FROM PREVIOUS INSPECTION

HOMOGENEOUS AREA: **09**
MATERIAL DESCRIPTION: **9"x9" Gray Floor Tile**
HISTORICAL AHERA DAMAGE CATEGORY **6 ACBM with the potential for damage**
HISTORICAL DAMAGE REASON:
HISTORICAL RESPONSE ACTION: **Operations and Maintenance**
ASBESTOS TYPE: **Chrysotile** FRIABLE: **No**

RESULTS OF REINSPECTION AND REASSESSMENT

This homogeneous area was reinspected and reassessed in accordance with Section 763.85 and 763.88 of AHERA and it's condition HAS NOT CHANGED when compared to the conditions of the last AHERA reinspection.

The current AHERA DAMAGE CATEGORY is determined to be **6. ACBM with the potential for damage**

DAMAGE REASON:

DISTURBANCE POTENTIAL: **MODERATE**

MATERIAL LOCATION: **Room 11**

MATERIAL QUANTITY: **780**

MATERIAL UNITS: **SF**

DAMAGE QUANTITY:

DAMAGE UNITS: **SF**

COMMENTS:

Inspector's Signature: _____

Date: **08/13/2013**

Chicago Public Schools

Carnow, Conibear and Associates

2013 AHERA REINSPECTION

Management Planner Review Form

LEA NAME: **Chicago Public Schools** UNIT NUMBER: **66381** BUIDLING ID: **3180**
CITY/STATE: **Chicago, Illinois** MANAGEMENT PLANNER: **Todd Huffer**
SCHOOL NAME: **Chicago International Charter - Wrightwood** REVIEW DATE: **8/13/2013**
ADDRESS: **8130 S. California Ave.** IDPH LICENSE NO: **100-08904**

HOMOGENEOUS AREA: **09**
MATERIAL DESCRIPTION: **9"x9" Gray Floor Tile**
MATERIAL LOCATION: **Room 11**
MATERIAL QUANTITY: **780** MATERIAL UNITS: **SF**
DAMAGE QUANTITY: **0** DAMAGE UNITS: **SF**

In accordance with Sections 763.88 and 763.90 of the Asbestos Hazard Emergency Response Act (AHERA) the LEA must select a management planner to review the results of the inspection and assessment and recommend appropriate response actions. The original inspection of the above identified homogeneous area has been reviewed in accordance with Sections 763.88 and 763.90 with the following recommendations.

The RESPONSE ACTION recommendation is:

Operations and Maintenance

Comments:

Management Planner's Signature: _____



Date: **08/13/2013**

Chicago Public Schools

Carnow, Conibear and Associates

2013 AHERA REINSPECTION

Inspector Assessment Form (REASSESSMENT)

LEA NAME: **Chicago Public Schools** UNIT NUMBER: **66381** BUIDLING ID: **3180**
CITY/STATE: **Chicago, Illinois** AHERA INSPECTOR: **Douglas McCormick**
SCHOOL NAME: **Chicago International Charter - Wrightwood** INSPECTION DATE: **8/13/2013**
ADDRESS: **8130 S. California Ave.** IDPH LICENSE NO: **100-08904**

INFORMATION FROM PREVIOUS INSPECTION

HOMOGENEOUS AREA: **10**
MATERIAL DESCRIPTION: **Boiler Insulation (ABATED 2004)**
HISTORICAL AHERA DAMAGE CATEGORY
HISTORICAL DAMAGE REASON:
HISTORICAL RESPONSE ACTION:
ASBESTOS TYPE: **Chrysotile** FRIABLE: **Yes**

RESULTS OF REINSPECTION AND REASSESSMENT

This homogeneous area was reinspected and reassessed in accordance with Section 763.85 and 763.88 of AHERA and it's condition HAS NOT CHANGED when compared to the conditions of the last AHERA reinspection.

The current AHERA DAMAGE CATEGORY is determined to be .

DAMAGE REASON:

DISTURBANCE POTENTIAL: **MODERATE**

MATERIAL LOCATION: **Boiler Room**

MATERIAL QUANTITY: MATERIAL UNITS:

DAMAGE QUANTITY: DAMAGE UNITS:

COMMENTS:

Inspector's Signature: _____ Date: 08/13/2013

Chicago Public Schools

Carnow, Conibear and Associates

2013 AHERA REINSPECTION

Management Planner Review Form

LEA NAME: **Chicago Public Schools** UNIT NUMBER: **66381** BUIDLING ID: **3180**
CITY/STATE: **Chicago, Illinois** MANAGEMENT PLANNER: **Todd Huffer**
SCHOOL NAME: **Chicago International Charter - Wrightwood** REVIEW DATE: **8/13/2013**
ADDRESS: **8130 S. California Ave.** IDPH LICENSE NO: **100-08904**

HOMOGENEOUS AREA: **10**

MATERIAL DESCRIPTION: **Boiler Insulation (ABATED 2004)**

MATERIAL LOCATION: **Boiler Room**

MATERIAL QUANTITY:

MATERIAL UNITS:

DAMAGE QUANTITY:

DAMAGE UNITS:

In accordance with Sections 763.88 and 763.90 of the Asbestos Hazard Emergency Response Act (AHERA) the LEA must select a management planner to review the results of the inspection and assessment and recommend appropriate response actions. The original inspection of the above identified homogeneous area has been reviewed in accordance with Sections 763.88 and 763.90 with the following recommendations.

The RESPONSE ACTION recommendation is:

Comments:

Abated 2004

Management Planner's Signature: _____



Date: **08/13/2013**

Chicago Public Schools

Carnow, Conibear and Associates

2013 AHERA REINSPECTION

Inspector Assessment Form (REASSESSMENT)

LEA NAME: **Chicago Public Schools** UNIT NUMBER: **66381** BUIDLING ID: **3180**
CITY/STATE: **Chicago, Illinois** AHERA INSPECTOR: **Douglas McCormick**
SCHOOL NAME: **Chicago International Charter - Wrightwood** INSPECTION DATE: **8/13/2013**
ADDRESS: **8130 S. California Ave.** IDPH LICENSE NO: **100-08904**

INFORMATION FROM PREVIOUS INSPECTION

HOMOGENEOUS AREA: **11**
MATERIAL DESCRIPTION: **12"x12" Floor Tile**
HISTORICAL AHERA DAMAGE CATEGORY **6 ACBM with the potential for damage**
HISTORICAL DAMAGE REASON:
HISTORICAL RESPONSE ACTION: **Operations and Maintenance**
ASBESTOS TYPE: **Chrysotile** FRIABLE: **No**

RESULTS OF REINSPECTION AND REASSESSMENT

This homogeneous area was reinspected and reassessed in accordance with Section 763.85 and 763.88 of AHERA and it's condition HAS NOT CHANGED when compared to the conditions of the last AHERA reinspection.

The current AHERA DAMAGE CATEGORY is determined to be **6. ACBM with the potential for damage**

DAMAGE REASON:

DISTURBANCE POTENTIAL: **MODERATE**

MATERIAL LOCATION: **1st Floor Storage Room**

MATERIAL QUANTITY: **100**

MATERIAL UNITS: **SF**

DAMAGE QUANTITY:

DAMAGE UNITS: **SF**

COMMENTS:

Inspector's Signature: _____

Date: 08/13/2013

Chicago Public Schools

Carnow, Conibear and Associates

2013 AHERA REINSPECTION

Management Planner Review Form

LEA NAME: **Chicago Public Schools** UNIT NUMBER: **66381** BUIDLING ID: **3180**
CITY/STATE: **Chicago, Illinois** MANAGEMENT PLANNER: **Todd Huffer**
SCHOOL NAME: **Chicago International Charter - Wrightwood** REVIEW DATE: **8/13/2013**
ADDRESS: **8130 S. California Ave.** IDPH LICENSE NO: **100-08904**

HOMOGENEOUS AREA: **11**
MATERIAL DESCRIPTION: **12"x12" Floor Tile**
MATERIAL LOCATION: **1st Floor Storage Room**
MATERIAL QUANTITY: **100** MATERIAL UNITS: **SF**
DAMAGE QUANTITY: **0** DAMAGE UNITS: **SF**

In accordance with Sections 763.88 and 763.90 of the Asbestos Hazard Emergency Response Act (AHERA) the LEA must select a management planner to review the results of the inspection and assessment and recommend appropriate response actions. The original inspection of the above identified homogeneous area has been reviewed in accordance with Sections 763.88 and 763.90 with the following recommendations.

The RESPONSE ACTION recommendation is:

Operations and Maintenance

Comments:

Management Planner's Signature: _____



Date: **08/13/2013**

Chicago Public Schools

Carnow, Conibear and Associates

2013 AHERA REINSPECTION

Inspector Assessment Form (REASSESSMENT)

LEA NAME: **Chicago Public Schools** UNIT NUMBER: **66381** BUIDLING ID: **3180**
CITY/STATE: **Chicago, Illinois** AHERA INSPECTOR: **Douglas McCormick**
SCHOOL NAME: **Chicago International Charter - Wrightwood** INSPECTION DATE: **8/13/2013**
ADDRESS: **8130 S. California Ave.** IDPH LICENSE NO: **100-08904**

INFORMATION FROM PREVIOUS INSPECTION

HOMOGENEOUS AREA: **12**
MATERIAL DESCRIPTION: **2x4 Ceiling Tile**
HISTORICAL AHERA DAMAGE CATEGORY **6 ACBM with the potential for damage**
HISTORICAL DAMAGE REASON:
HISTORICAL RESPONSE ACTION: **Operations and Maintenance**
ASBESTOS TYPE: **Assumed** FRIABLE: **Yes**

RESULTS OF REINSPECTION AND REASSESSMENT

This homogeneous area was reinspected and reassessed in accordance with Section 763.85 and 763.88 of AHERA and it's condition HAS NOT CHANGED when compared to the conditions of the last AHERA reinspection.

The current AHERA DAMAGE CATEGORY is determined to be **6. ACBM with the potential for damage**

DAMAGE REASON:

DISTURBANCE POTENTIAL: **MODERATE**

MATERIAL LOCATION: **Bldg A - 1st and 2nd Floor Hallways**

MATERIAL QUANTITY: **4220** MATERIAL UNITS: **SF**

DAMAGE QUANTITY: DAMAGE UNITS: **SF**

COMMENTS:

Inspector's Signature: _____ Date: **08/13/2013**

Chicago Public Schools

Carnow, Conibear and Associates

2013 AHERA REINSPECTION

Management Planner Review Form

LEA NAME: **Chicago Public Schools** UNIT NUMBER: **66381** BUIDLING ID: **3180**
CITY/STATE: **Chicago, Illinois** MANAGEMENT PLANNER: **Todd Huffer**
SCHOOL NAME: **Chicago International Charter - Wrightwood** REVIEW DATE: **8/13/2013**
ADDRESS: **8130 S. California Ave.** IDPH LICENSE NO: **100-08904**

HOMOGENEOUS AREA: **12**
MATERIAL DESCRIPTION: **2x4 Ceiling Tile**
MATERIAL LOCATION: **Bldg A - 1st and 2nd Floor Hallways**
MATERIAL QUANTITY: **4220** MATERIAL UNITS: **SF**
DAMAGE QUANTITY: **0** DAMAGE UNITS: **SF**

In accordance with Sections 763.88 and 763.90 of the Asbestos Hazard Emergency Response Act (AHERA) the LEA must select a management planner to review the results of the inspection and assessment and recommend appropriate response actions. The original inspection of the above identified homogeneous area has been reviewed in accordance with Sections 763.88 and 763.90 with the following recommendations.

The RESPONSE ACTION recommendation is:

Operations and Maintenance

Comments:

Management Planner's Signature: _____



Date: **08/13/2013**

Chicago Public Schools

Carnow, Conibear and Associates

2013 AHERA REINSPECTION

Inspector Assessment Form (REASSESSMENT)

LEA NAME: **Chicago Public Schools** UNIT NUMBER: **66381** BUIDLING ID: **3180**
CITY/STATE: **Chicago, Illinois** AHERA INSPECTOR: **Douglas McCormick**
SCHOOL NAME: **Chicago International Charter - Wrightwood** INSPECTION DATE: **8/13/2013**
ADDRESS: **8130 S. California Ave.** IDPH LICENSE NO: **100-08904**

INFORMATION FROM PREVIOUS INSPECTION

HOMOGENEOUS AREA: **13**
MATERIAL DESCRIPTION: **Red and Beige Terrazzo**
HISTORICAL AHERA DAMAGE CATEGORY **6 ACBM with the potential for damage**
HISTORICAL DAMAGE REASON:
HISTORICAL RESPONSE ACTION: **Operations and Maintenance**
ASBESTOS TYPE: **Assumed** FRIABLE: **No**

RESULTS OF REINSPECTION AND REASSESSMENT

This homogeneous area was reinspected and reassessed in accordance with Section 763.85 and 763.88 of AHERA and it's condition HAS NOT CHANGED when compared to the conditions of the last AHERA reinspection.

The current AHERA DAMAGE CATEGORY is determined to be **6. ACBM with the potential for damage**

DAMAGE REASON:

DISTURBANCE POTENTIAL: **MODERATE**

MATERIAL LOCATION: **Buildings A and B - Hallways, Stairwells, Bathroom**

MATERIAL QUANTITY: **15000** MATERIAL UNITS: **SF**

DAMAGE QUANTITY: DAMAGE UNITS: **SF**

COMMENTS:

Inspector's Signature: _____ Date: **08/13/2013**

Chicago Public Schools

Carnow, Conibear and Associates

2013 AHERA REINSPECTION

Management Planner Review Form

LEA NAME: **Chicago Public Schools** UNIT NUMBER: **66381** BUIDLING ID: **3180**
CITY/STATE: **Chicago, Illinois** MANAGEMENT PLANNER: **Todd Huffer**
SCHOOL NAME: **Chicago International Charter - Wrightwood** REVIEW DATE: **8/13/2013**
ADDRESS: **8130 S. California Ave.** IDPH LICENSE NO: **100-08904**

HOMOGENEOUS AREA: **13**
MATERIAL DESCRIPTION: **Red and Beige Terrazzo**
MATERIAL LOCATION: **Buildings A and B - Hallways, Stairwells, Bathroom**
MATERIAL QUANTITY: **15000** MATERIAL UNITS: **SF**
DAMAGE QUANTITY: **0** DAMAGE UNITS: **SF**

In accordance with Sections 763.88 and 763.90 of the Asbestos Hazard Emergency Response Act (AHERA) the LEA must select a management planner to review the results of the inspection and assessment and recommend appropriate response actions. The original inspection of the above identified homogeneous area has been reviewed in accordance with Sections 763.88 and 763.90 with the following recommendations.

The RESPONSE ACTION recommendation is:

Operations and Maintenance

Comments:

Management Planner's Signature: _____



Date: **08/13/2013**

Chicago Public Schools

Carnow, Conibear and Associates

2013 AHERA REINSPECTION

Inspector Assessment Form (REASSESSMENT)

LEA NAME: **Chicago Public Schools** UNIT NUMBER: **66381** BUIDLING ID: **3180**
CITY/STATE: **Chicago, Illinois** AHERA INSPECTOR: **Douglas McCormick**
SCHOOL NAME: **Chicago International Charter - Wrightwood** INSPECTION DATE: **8/13/2013**
ADDRESS: **8130 S. California Ave.** IDPH LICENSE NO: **100-08904**

INFORMATION FROM PREVIOUS INSPECTION

HOMOGENEOUS AREA: **14**
MATERIAL DESCRIPTION: **Carpet Mastic over Tile**
HISTORICAL AHERA DAMAGE CATEGORY **6 ACBM with the potential for damage**
HISTORICAL DAMAGE REASON:
HISTORICAL RESPONSE ACTION: **Operations and Maintenance**
ASBESTOS TYPE: **Assumed** FRIABLE: **No**

RESULTS OF REINSPECTION AND REASSESSMENT

This homogeneous area was reinspected and reassessed in accordance with Section 763.85 and 763.88 of AHERA and it's condition HAS NOT CHANGED when compared to the conditions of the last AHERA reinspection.

The current AHERA DAMAGE CATEGORY is determined to be **6. ACBM with the potential for damage**

DAMAGE REASON:

DISTURBANCE POTENTIAL: **MODERATE**
MATERIAL LOCATION: **Rooms 11, 17-18, 21, 25-32, and Library Offices**
MATERIAL QUANTITY: **3500** MATERIAL UNITS: **SF**
DAMAGE QUANTITY: DAMAGE UNITS: **SF**
COMMENTS:

Inspector's Signature: _____ Date: **08/13/2013**

Chicago Public Schools

Carnow, Conibear and Associates

2013 AHERA REINSPECTION

Management Planner Review Form

LEA NAME: **Chicago Public Schools** UNIT NUMBER: **66381** BUIDLING ID: **3180**
CITY/STATE: **Chicago, Illinois** MANAGEMENT PLANNER: **Todd Huffer**
SCHOOL NAME: **Chicago International Charter - Wrightwood** REVIEW DATE: **8/13/2013**
ADDRESS: **8130 S. California Ave.** IDPH LICENSE NO: **100-08904**

HOMOGENEOUS AREA: **14**
MATERIAL DESCRIPTION: **Carpet Mastic over Tile**
MATERIAL LOCATION: **Rooms 11, 17-18, 21, 25-32, and Library Offices**
MATERIAL QUANTITY: **3500** MATERIAL UNITS: **SF**
DAMAGE QUANTITY: **0** DAMAGE UNITS: **SF**

In accordance with Sections 763.88 and 763.90 of the Asbestos Hazard Emergency Response Act (AHERA) the LEA must select a management planner to review the results of the inspection and assessment and recommend appropriate response actions. The original inspection of the above identified homogeneous area has been reviewed in accordance with Sections 763.88 and 763.90 with the following recommendations.

The RESPONSE ACTION recommendation is:

Operations and Maintenance

Comments:

Management Planner's Signature: _____



Date: **08/13/2013**

Chicago Public Schools

Carnow, Conibear and Associates

2013 AHERA REINSPECTION

Inspector Assessment Form (REASSESSMENT)

LEA NAME: **Chicago Public Schools** UNIT NUMBER: **66381** BUIDLING ID: **3180**
CITY/STATE: **Chicago, Illinois** AHERA INSPECTOR: **Douglas McCormick**
SCHOOL NAME: **Chicago International Charter - Wrightwood** INSPECTION DATE: **8/13/2013**
ADDRESS: **8130 S. California Ave.** IDPH LICENSE NO: **100-08904**

INFORMATION FROM PREVIOUS INSPECTION

HOMOGENEOUS AREA: **15**
MATERIAL DESCRIPTION: **12 x 12 Brown Floor Tile**
HISTORICAL AHERA DAMAGE CATEGORY **6 ACBM with the potential for damage**
HISTORICAL DAMAGE REASON:
HISTORICAL RESPONSE ACTION: **Operations and Maintenance**
ASBESTOS TYPE: **Assumed** FRIABLE: **No**

RESULTS OF REINSPECTION AND REASSESSMENT

This homogeneous area was reinspected and reassessed in accordance with Section 763.85 and 763.88 of AHERA and it's condition HAS NOT CHANGED when compared to the conditions of the last AHERA reinspection.

The current AHERA DAMAGE CATEGORY is determined to be **6. ACBM with the potential for damage**

DAMAGE REASON:

DISTURBANCE POTENTIAL: **MODERATE**

MATERIAL LOCATION: **Rooms 12, 19, 20 and 23**

MATERIAL QUANTITY: **2000**

MATERIAL UNITS: **SF**

DAMAGE QUANTITY:

DAMAGE UNITS: **SF**

COMMENTS:

Inspector's Signature: _____

Date: 08/13/2013

Chicago Public Schools

Carnow, Conibear and Associates

2013 AHERA REINSPECTION

Management Planner Review Form

LEA NAME: **Chicago Public Schools** UNIT NUMBER: **66381** BUIDLING ID: **3180**
CITY/STATE: **Chicago, Illinois** MANAGEMENT PLANNER: **Todd Huffer**
SCHOOL NAME: **Chicago International Charter - Wrightwood** REVIEW DATE: **8/13/2013**
ADDRESS: **8130 S. California Ave.** IDPH LICENSE NO: **100-08904**

HOMOGENEOUS AREA: **15**
MATERIAL DESCRIPTION: **12 x 12 Brown Floor Tile**
MATERIAL LOCATION: **Rooms 12, 19, 20 and 23**
MATERIAL QUANTITY: **2000** MATERIAL UNITS: **SF**
DAMAGE QUANTITY: **0** DAMAGE UNITS: **SF**

In accordance with Sections 763.88 and 763.90 of the Asbestos Hazard Emergency Response Act (AHERA) the LEA must select a management planner to review the results of the inspection and assessment and recommend appropriate response actions. The original inspection of the above identified homogeneous area has been reviewed in accordance with Sections 763.88 and 763.90 with the following recommendations.

The RESPONSE ACTION recommendation is:

Operations and Maintenance

Comments:

Management Planner's Signature: _____



Date: **08/13/2013**

Chicago Public Schools

Carnow, Conibear and Associates

2013 AHERA REINSPECTION

Inspector Assessment Form (REASSESSMENT)

LEA NAME: **Chicago Public Schools** UNIT NUMBER: **66381** BUIDLING ID: **3180**
CITY/STATE: **Chicago, Illinois** AHERA INSPECTOR: **Douglas McCormick**
SCHOOL NAME: **Chicago International Charter - Wrightwood** INSPECTION DATE: **8/13/2013**
ADDRESS: **8130 S. California Ave.** IDPH LICENSE NO: **100-08904**

INFORMATION FROM PREVIOUS INSPECTION

HOMOGENEOUS AREA: **16**
MATERIAL DESCRIPTION: **12 x 12 Brown Floor Tile Mastic**
HISTORICAL AHERA DAMAGE CATEGORY **6 ACBM with the potential for damage**
HISTORICAL DAMAGE REASON:
HISTORICAL RESPONSE ACTION: **Operations and Maintenance**
ASBESTOS TYPE: **Assumed** FRIABLE: **No**

RESULTS OF REINSPECTION AND REASSESSMENT

This homogeneous area was reinspected and reassessed in accordance with Section 763.85 and 763.88 of AHERA and it's condition HAS NOT CHANGED when compared to the conditions of the last AHERA reinspection.

The current AHERA DAMAGE CATEGORY is determined to be **6. ACBM with the potential for damage**

DAMAGE REASON:

DISTURBANCE POTENTIAL: **MODERATE**

MATERIAL LOCATION: **Rooms 12, 19, 20 and 23**

MATERIAL QUANTITY: **2000**

MATERIAL UNITS: **SF**

DAMAGE QUANTITY:

DAMAGE UNITS: **SF**

COMMENTS:

Inspector's Signature: _____

Date: **08/13/2013**

Chicago Public Schools

Carnow, Conibear and Associates

2013 AHERA REINSPECTION

Management Planner Review Form

LEA NAME: **Chicago Public Schools** UNIT NUMBER: **66381** BUIDLING ID: **3180**
CITY/STATE: **Chicago, Illinois** MANAGEMENT PLANNER: **Todd Huffer**
SCHOOL NAME: **Chicago International Charter - Wrightwood** REVIEW DATE: **8/13/2013**
ADDRESS: **8130 S. California Ave.** IDPH LICENSE NO: **100-08904**

HOMOGENEOUS AREA: **16**
MATERIAL DESCRIPTION: **12 x 12 Brown Floor Tile Mastic**
MATERIAL LOCATION: **Rooms 12, 19, 20 and 23**
MATERIAL QUANTITY: **2000** MATERIAL UNITS: **SF**
DAMAGE QUANTITY: **0** DAMAGE UNITS: **SF**

In accordance with Sections 763.88 and 763.90 of the Asbestos Hazard Emergency Response Act (AHERA) the LEA must select a management planner to review the results of the inspection and assessment and recommend appropriate response actions. The original inspection of the above identified homogeneous area has been reviewed in accordance with Sections 763.88 and 763.90 with the following recommendations.

The RESPONSE ACTION recommendation is:

Operations and Maintenance

Comments:

Management Planner's Signature: _____



Date: **08/13/2013**

Chicago Public Schools

Carnow, Conibear and Associates

2013 AHERA REINSPECTION

Inspector Assessment Form (REASSESSMENT)

LEA NAME: **Chicago Public Schools** UNIT NUMBER: **66381** BUIDLING ID: **3180**
CITY/STATE: **Chicago, Illinois** AHERA INSPECTOR: **Douglas McCormick**
SCHOOL NAME: **Chicago International Charter - Wrightwood** INSPECTION DATE: **8/13/2013**
ADDRESS: **8130 S. California Ave.** IDPH LICENSE NO: **100-08904**

INFORMATION FROM PREVIOUS INSPECTION

HOMOGENEOUS AREA: **17**
MATERIAL DESCRIPTION: **12 x 12 Beige Floor Tile**
HISTORICAL AHERA DAMAGE CATEGORY **6 ACBM with the potential for damage**
HISTORICAL DAMAGE REASON:
HISTORICAL RESPONSE ACTION: **Operations and Maintenance**
ASBESTOS TYPE: **Assumed** FRIABLE: **No**

RESULTS OF REINSPECTION AND REASSESSMENT

This homogeneous area was reinspected and reassessed in accordance with Section 763.85 and 763.88 of AHERA and it's condition HAS NOT CHANGED when compared to the conditions of the last AHERA reinspection.

The current AHERA DAMAGE CATEGORY is determined to be **6. ACBM with the potential for damage**

DAMAGE REASON:

DISTURBANCE POTENTIAL: **MODERATE**

MATERIAL LOCATION: **Kitchen/Basement**

MATERIAL QUANTITY: **9000**

MATERIAL UNITS: **SF**

DAMAGE QUANTITY:

DAMAGE UNITS: **SF**

COMMENTS:

Inspector's Signature: _____

Date: **08/13/2013**

Chicago Public Schools

Carnow, Conibear and Associates

2013 AHERA REINSPECTION

Management Planner Review Form

LEA NAME: **Chicago Public Schools** UNIT NUMBER: **66381** BUIDLING ID: **3180**
CITY/STATE: **Chicago, Illinois** MANAGEMENT PLANNER: **Todd Huffer**
SCHOOL NAME: **Chicago International Charter - Wrightwood** REVIEW DATE: **8/13/2013**
ADDRESS: **8130 S. California Ave.** IDPH LICENSE NO: **100-08904**

HOMOGENEOUS AREA: **17**
MATERIAL DESCRIPTION: **12 x 12 Beige Floor Tile**
MATERIAL LOCATION: **Kitchen/Basement**
MATERIAL QUANTITY: **9000** MATERIAL UNITS: **SF**
DAMAGE QUANTITY: **0** DAMAGE UNITS: **SF**

In accordance with Sections 763.88 and 763.90 of the Asbestos Hazard Emergency Response Act (AHERA) the LEA must select a management planner to review the results of the inspection and assessment and recommend appropriate response actions. The original inspection of the above identified homogeneous area has been reviewed in accordance with Sections 763.88 and 763.90 with the following recommendations.

The RESPONSE ACTION recommendation is:

Operations and Maintenance

Comments:

Management Planner's Signature: _____



Date: **08/13/2013**

Chicago Public Schools

Carnow, Conibear and Associates

2013 AHERA REINSPECTION

Inspector Assessment Form (REASSESSMENT)

LEA NAME: **Chicago Public Schools** UNIT NUMBER: **66381** BUIDLING ID: **3180**
CITY/STATE: **Chicago, Illinois** AHERA INSPECTOR: **Douglas McCormick**
SCHOOL NAME: **Chicago International Charter - Wrightwood** INSPECTION DATE: **8/13/2013**
ADDRESS: **8130 S. California Ave.** IDPH LICENSE NO: **100-08904**

INFORMATION FROM PREVIOUS INSPECTION

HOMOGENEOUS AREA: **18**
MATERIAL DESCRIPTION: **12 x 12 Red Floor Tile**
HISTORICAL AHERA DAMAGE CATEGORY **6 ACBM with the potential for damage**
HISTORICAL DAMAGE REASON:
HISTORICAL RESPONSE ACTION: **Operations and Maintenance**
ASBESTOS TYPE: **Assumed** FRIABLE: **No**

RESULTS OF REINSPECTION AND REASSESSMENT

This homogeneous area was reinspected and reassessed in accordance with Section 763.85 and 763.88 of AHERA and it's condition HAS NOT CHANGED when compared to the conditions of the last AHERA reinspection.

The current AHERA DAMAGE CATEGORY is determined to be **6. ACBM with the potential for damage**

DAMAGE REASON:

DISTURBANCE POTENTIAL: **MODERATE**

MATERIAL LOCATION: **Science / Storage**

MATERIAL QUANTITY: **968**

MATERIAL UNITS: **SF**

DAMAGE QUANTITY:

DAMAGE UNITS: **SF**

COMMENTS:

Inspector's Signature: _____

Date: **08/13/2013**

Chicago Public Schools

Carnow, Conibear and Associates

2013 AHERA REINSPECTION

Management Planner Review Form

LEA NAME: **Chicago Public Schools** UNIT NUMBER: **66381** BUIDLING ID: **3180**
CITY/STATE: **Chicago, Illinois** MANAGEMENT PLANNER: **Todd Huffer**
SCHOOL NAME: **Chicago International Charter - Wrightwood** REVIEW DATE: **8/13/2013**
ADDRESS: **8130 S. California Ave.** IDPH LICENSE NO: **100-08904**

HOMOGENEOUS AREA: **18**
MATERIAL DESCRIPTION: **12 x 12 Red Floor Tile**
MATERIAL LOCATION: **Science / Storage**
MATERIAL QUANTITY: **968** MATERIAL UNITS: **SF**
DAMAGE QUANTITY: **0** DAMAGE UNITS: **SF**

In accordance with Sections 763.88 and 763.90 of the Asbestos Hazard Emergency Response Act (AHERA) the LEA must select a management planner to review the results of the inspection and assessment and recommend appropriate response actions. The original inspection of the above identified homogeneous area has been reviewed in accordance with Sections 763.88 and 763.90 with the following recommendations.

The RESPONSE ACTION recommendation is:

Operations and Maintenance

Comments:

Management Planner's Signature: _____



Date: **08/13/2013**

Chicago Public Schools

Carnow, Conibear and Associates

2013 AHERA REINSPECTION

Inspector Assessment Form (REASSESSMENT)

LEA NAME: **Chicago Public Schools** UNIT NUMBER: **66381** BUIDLING ID: **3180**
CITY/STATE: **Chicago, Illinois** AHERA INSPECTOR: **Douglas McCormick**
SCHOOL NAME: **Chicago International Charter - Wrightwood** INSPECTION DATE: **8/13/2013**
ADDRESS: **8130 S. California Ave.** IDPH LICENSE NO: **100-08904**

INFORMATION FROM PREVIOUS INSPECTION

HOMOGENEOUS AREA: **19**
MATERIAL DESCRIPTION: **9 x 9 Green Floor Tile Mastic**
HISTORICAL AHERA DAMAGE CATEGORY **6 ACBM with the potential for damage**
HISTORICAL DAMAGE REASON:
HISTORICAL RESPONSE ACTION: **Operations and Maintenance**
ASBESTOS TYPE: **Assumed** FRIABLE: **No**

RESULTS OF REINSPECTION AND REASSESSMENT

This homogeneous area was reinspected and reassessed in accordance with Section 763.85 and 763.88 of AHERA and it's condition HAS NOT CHANGED when compared to the conditions of the last AHERA reinspection.

The current AHERA DAMAGE CATEGORY is determined to be **6. ACBM with the potential for damage**

DAMAGE REASON:

DISTURBANCE POTENTIAL: **MODERATE**

MATERIAL LOCATION: **Rooms 4, 8, 19, 20-21, 28, 31, 33, 35, 37**

MATERIAL QUANTITY: **3900**

MATERIAL UNITS: **SF**

DAMAGE QUANTITY:

DAMAGE UNITS: **SF**

COMMENTS:

Inspector's Signature: _____

Date: **08/13/2013**

Chicago Public Schools

Carnow, Conibear and Associates

2013 AHERA REINSPECTION

Management Planner Review Form

LEA NAME: **Chicago Public Schools** UNIT NUMBER: **66381** BUIDLING ID: **3180**
CITY/STATE: **Chicago, Illinois** MANAGEMENT PLANNER: **Todd Huffer**
SCHOOL NAME: **Chicago International Charter - Wrightwood** REVIEW DATE: **8/13/2013**
ADDRESS: **8130 S. California Ave.** IDPH LICENSE NO: **100-08904**

HOMOGENEOUS AREA: **19**
MATERIAL DESCRIPTION: **9 x 9 Green Floor Tile Mastic**
MATERIAL LOCATION: **Rooms 4, 8, 19, 20-21, 28, 31, 33, 35, 37**
MATERIAL QUANTITY: **3900** MATERIAL UNITS: **SF**
DAMAGE QUANTITY: **0** DAMAGE UNITS: **SF**

In accordance with Sections 763.88 and 763.90 of the Asbestos Hazard Emergency Response Act (AHERA) the LEA must select a management planner to review the results of the inspection and assessment and recommend appropriate response actions. The original inspection of the above identified homogeneous area has been reviewed in accordance with Sections 763.88 and 763.90 with the following recommendations.

The RESPONSE ACTION recommendation is:

Operations and Maintenance

Comments:

Management Planner's Signature: _____



Date: **08/13/2013**

Chicago Public Schools

Carnow, Conibear and Associates

2013 AHERA REINSPECTION

Inspector Assessment Form (REASSESSMENT)

LEA NAME: **Chicago Public Schools** UNIT NUMBER: **66381** BUIDLING ID: **3180**
CITY/STATE: **Chicago, Illinois** AHERA INSPECTOR: **Douglas McCormick**
SCHOOL NAME: **Chicago International Charter - Wrightwood** INSPECTION DATE: **8/13/2013**
ADDRESS: **8130 S. California Ave.** IDPH LICENSE NO: **100-08904**

INFORMATION FROM PREVIOUS INSPECTION

HOMOGENEOUS AREA: **20**
MATERIAL DESCRIPTION: **9" x 9" Tan Floor Tile Mastic**
HISTORICAL AHERA DAMAGE CATEGORY **6 ACBM with the potential for damage**
HISTORICAL DAMAGE REASON:
HISTORICAL RESPONSE ACTION: **Operations and Maintenance**
ASBESTOS TYPE: **Assumed** FRIABLE: **No**

RESULTS OF REINSPECTION AND REASSESSMENT

This homogeneous area was reinspected and reassessed in accordance with Section 763.85 and 763.88 of AHERA and it's condition HAS NOT CHANGED when compared to the conditions of the last AHERA reinspection.

The current AHERA DAMAGE CATEGORY is determined to be **6. ACBM with the potential for damage**

DAMAGE REASON:

DISTURBANCE POTENTIAL: **MODERATE**

MATERIAL LOCATION: **Rooms 4, 8, 19-21, 28, 31, 33, 35 & 37**

MATERIAL QUANTITY: **3900** MATERIAL UNITS: **SF**

DAMAGE QUANTITY: DAMAGE UNITS: **SF**

COMMENTS:

Inspector's Signature: _____ Date: **08/13/2013**

Chicago Public Schools

Carnow, Conibear and Associates

2013 AHERA REINSPECTION

Management Planner Review Form

LEA NAME: **Chicago Public Schools** UNIT NUMBER: **66381** BUIDLING ID: **3180**
CITY/STATE: **Chicago, Illinois** MANAGEMENT PLANNER: **Todd Huffer**
SCHOOL NAME: **Chicago International Charter - Wrightwood** REVIEW DATE: **8/13/2013**
ADDRESS: **8130 S. California Ave.** IDPH LICENSE NO: **100-08904**

HOMOGENEOUS AREA: **20**
MATERIAL DESCRIPTION: **9" x 9" Tan Floor Tile Mastic**
MATERIAL LOCATION: **Rooms 4, 8, 19-21, 28, 31, 33, 35 & 37**
MATERIAL QUANTITY: **3900** MATERIAL UNITS: **SF**
DAMAGE QUANTITY: **0** DAMAGE UNITS: **SF**

In accordance with Sections 763.88 and 763.90 of the Asbestos Hazard Emergency Response Act (AHERA) the LEA must select a management planner to review the results of the inspection and assessment and recommend appropriate response actions. The original inspection of the above identified homogeneous area has been reviewed in accordance with Sections 763.88 and 763.90 with the following recommendations.

The RESPONSE ACTION recommendation is:

Operations and Maintenance

Comments:

Management Planner's Signature: _____



Date: **08/13/2013**

Chicago Public Schools

Carnow, Conibear and Associates

2013 AHERA REINSPECTION

Inspector Assessment Form (New Homogeneous Area)

LEA NAME: **Chicago Public Schools** UNIT NUMBER: **66381** BUIDLING ID: **3180**
CITY/STATE: **Chicago, Illinois** AHERA INSPECTOR: **Douglas McCormick**
SCHOOL NAME: **Chicago International Charter - Wrightwood** INSPECTION DATE: **8/13/2013**
ADDRESS: **8130 S. California Ave.** IDPH LICENSE NO: **100-08904**

INFORMATION FROM CURRENT INSPECTION

HOMOGENEOUS AREA: **23**
MATERIAL DESCRIPTION: **12" x 12" Tan Floor Tile w/Brown Streaks**
MATERIAL LOCATION: **Rooms 2, 4, 6, 7, 8 & 15**
MATERIAL QUANTITY: **5488** MATERIAL UNITS: **SF**
MATERIAL CATEGORY: **MISC** FRIABLE: **No**
ASBESTOS TYPE: **Assumed**
DISTURBANCE POTENTIAL: **MODERATE** CONDITION:
AHERA DAMAGE CATEGORY: **6 ACBM with the potential for damage**
ACCESSIBILITY: **Within Reach** DAMAGE REASON:
DAMAGE QUANTITY: **0** DAMAGE REASON:
DAMAGE UNITS: **SF**
COMMENTS:

Inspector's Signature: _____ Date: 08/13/2013

Chicago Public Schools

Carnow, Conibear and Associates

2013 AHERA REINSPECTION

Management Planner Review Form

LEA NAME: **Chicago Public Schools** UNIT NUMBER: **66381** BUILDING ID: **3180**
CITY/STATE: **Chicago, Illinois** MANAGEMENT PLANNER: **Todd Huffer**
SCHOOL NAME: **Chicago International Charter - Wrightwood** REVIEW DATE: **8/13/2013**
ADDRESS: **8130 S. California Ave.** IDPH LICENSE NO: **100-08904**

HOMOGENEOUS AREA: **23**
MATERIAL DESCRIPTION: **12" x 12" Tan Floor Tile w/Brown Streaks**
MATERIAL LOCATION: **Rooms 2, 4, 6, 7, 8 & 15**
MATERIAL QUANTITY: **5488** MATERIAL UNITS: **SF**
DAMAGE QUANTITY: **0** DAMAGE UNITS: **SF**

In accordance with Sections 763.88 and 763.90 of the Asbestos Hazard Emergency Response Act (AHERA) the LEA must select a management planner to review the results of the inspection and assessment and recommend appropriate response actions. The original inspection of the above identified homogeneous area has been reviewed in accordance with Sections 763.88 and 763.90 with the following recommendations.

The RESPONSE ACTION recommendation is:

COMMENTS:

Management Planner's Signature:  _____ Date: **08/13/2013** _____

K/CSPS 2013/013 Three Years/Car Drawing/Region: CICS/CICS - Wrightwood Campus/CICS - Wrightwood Building A - First Floor East/ing

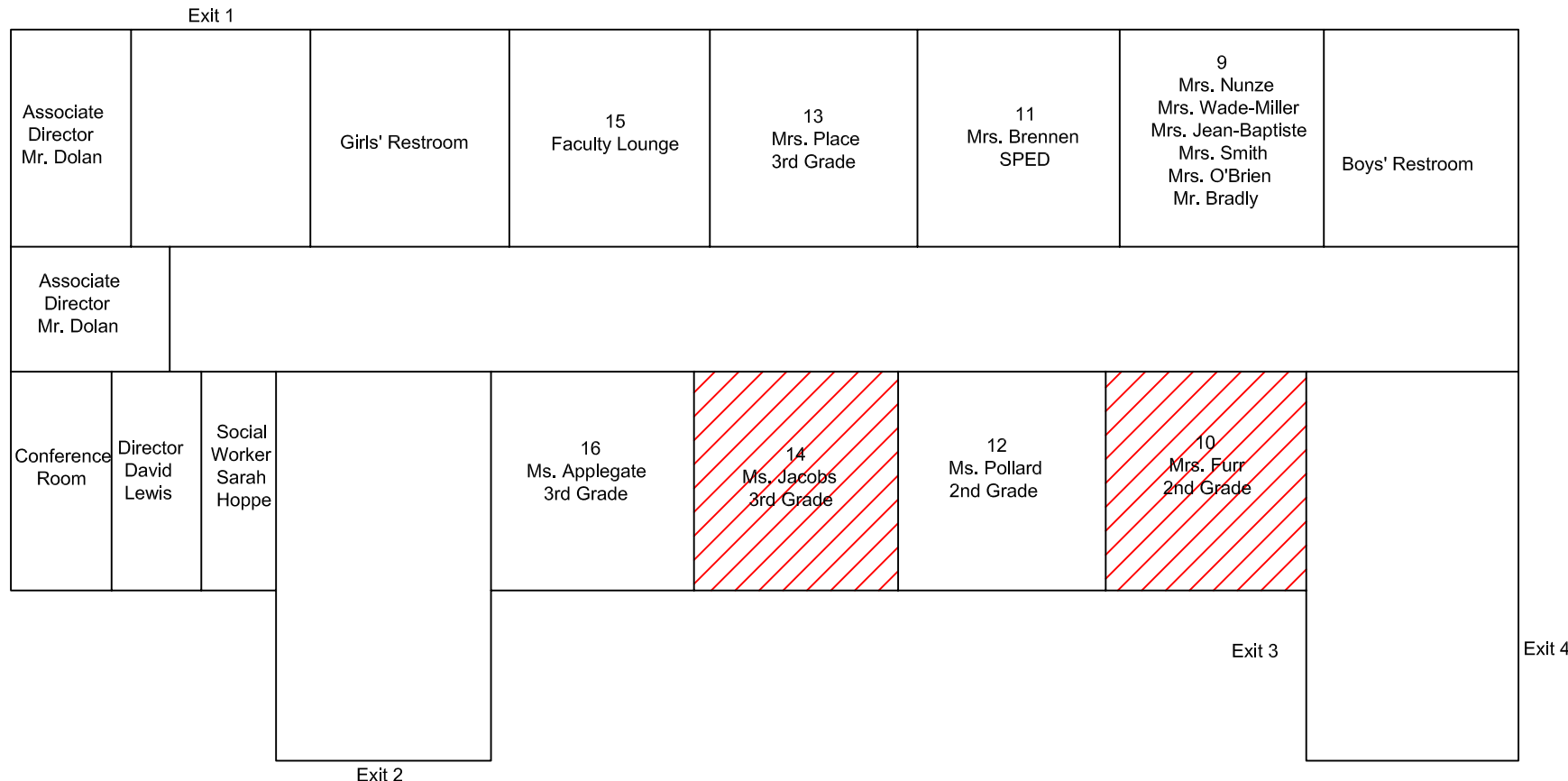

ASBESTOS REINSPECTION KEY NOTES:

 HA-21 12" x 12" Beige Floor Tile with Grey Streaks

CICS - Wrightwood Building A - First Floor East
2013 Asbestos Reinspection

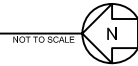

CLIENT: Chicago Public Schools 125 South Clark Street, Chicago, Illinois 60603	PROJECT NAME: 2013 AHERA Reinspection CICS-Wrightwood 8130 South California Avenue Chicago, IL 60652	SHEET NAME: CICS - Wrightwood Building A - First Floor East - HA-21	DRAWN BY: KF	DATE: 8/15/2013	CHECKED BY: DM	Carnow, Conibear & Assoc., Ltd. Environmental Consulting Services 600 W. Van Buren St., Suite 500, Chicago, IL 60607 t: 312.782.4486 f: 312.782.5145 www.cca ltd.com	CCA PROJECT NUMBER A32013-0001-434
			REVISD BY:	DATE:	CHECKED BY:		DATE: 08/15/2013
		INSPECTED BY: Douglas McCormick	IDPH License #: 100- 08904				SHEET NUMBER HA-21

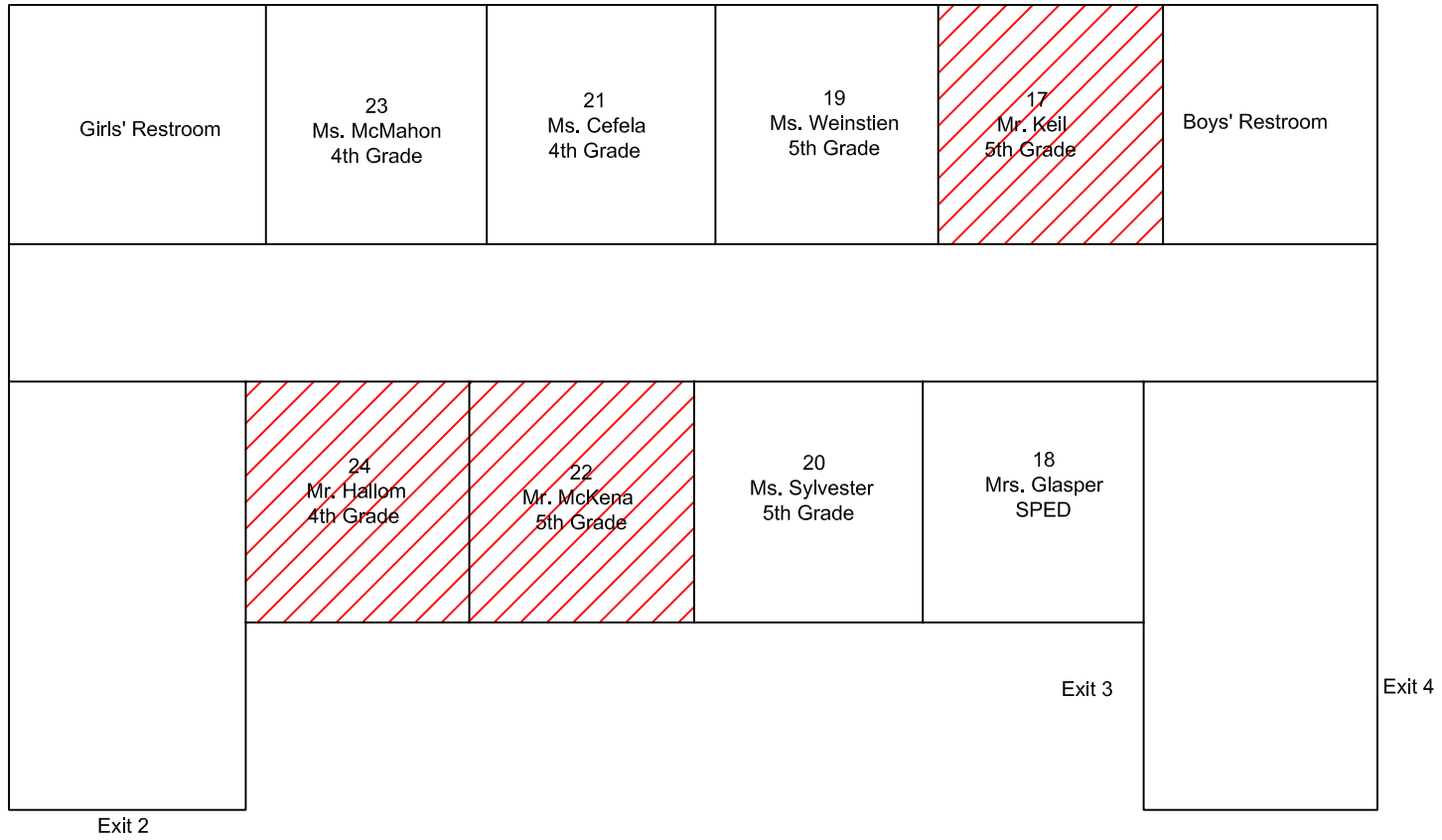

ASBESTOS REINSPECTION KEY NOTES:

 HA-21 12" x 12" Beige Floor Tile with Grey Streaks

CICS - Wrightwood Building A - Second Floor East
2013 Asbestos Reinspection

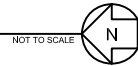

CLIENT: Chicago Public Schools 125 South Clark Street, Chicago, Illinois 60603	PROJECT NAME: 2013 AHERA Reinspection CICS-Wrightwood 8130 South California Avenue Chicago, IL 60652	SHEET NAME: CICS - Wrightwood Building A - Second Floor East - HA-21	DRAWN BY: KF DATE: 8/15/2013 CHECKED BY: DM	CCA PROJECT NUMBER A32013-0001-434	
			REVISD BY: DATE: CHECKED BY:		DATE: 08/15/2013
			REVISD BY: DATE: CHECKED BY:		SHEET NUMBER HA-21
INSPECTED BY: Douglas McCormick			IDPH License #:100- 08904	Carnow, Conibear & Assoc., Ltd. Environmental Consulting Services 600 W. Van Buren St., Suite 500, Chicago, IL 60607 t: 312.782.4486 f: 312.782.5145 www.ccaltd.com	



C:\CPS\2013\0815 Three Year Asst Drafting\Region 5\CICS - Wrightwood Campus\CICS - Wrightwood Building A - Second Floor East.dwg

Chicago Public Schools

Carnow, Conibear and Associates

2013 AHERA REINSPECTION

Inspector Assessment Form (New Homogeneous Area)

LEA NAME: **Chicago Public Schools** UNIT NUMBER: **66381** BUIDLING ID: **3180**
CITY/STATE: **Chicago, Illinois** AHERA INSPECTOR: **Douglas McCormick**
SCHOOL NAME: **Chicago International Charter - Wrightwood** INSPECTION DATE: **8/13/2013**
ADDRESS: **8130 S. California Ave.** IDPH LICENSE NO: **100-08904**

INFORMATION FROM CURRENT INSPECTION

HOMOGENEOUS AREA: **24**
MATERIAL DESCRIPTION: **12" x 12" Tan Floor Tile w/Brown Streaks Mastic**
MATERIAL LOCATION: **Rooms 2, 4, 6, 7, 8 & 15**
MATERIAL QUANTITY: **5488** MATERIAL UNITS: **SF**
MATERIAL CATEGORY: **MISC** FRIABLE: **No**
ASBESTOS TYPE: **Assumed**
DISTURBANCE POTENTIAL: **MODERATE** CONDITION:
AHERA DAMAGE CATEGORY: **6 ACBM with the potential for damage**
ACCESSIBILITY: **Within Reach** DAMAGE REASON:
DAMAGE QUANTITY: **0** DAMAGE REASON:
DAMAGE UNITS: **SF**
COMMENTS:

Inspector's Signature: _____ Date: 08/13/2013

Chicago Public Schools

Carnow, Conibear and Associates

2013 AHERA REINSPECTION

Management Planner Review Form

LEA NAME: **Chicago Public Schools** UNIT NUMBER: **66381** BUILDING ID: **3180**
CITY/STATE: **Chicago, Illinois** MANAGEMENT PLANNER: **Todd Huffer**
SCHOOL NAME: **Chicago International Charter - Wrightwood** REVIEW DATE: **8/13/2013**
ADDRESS: **8130 S. California Ave.** IDPH LICENSE NO: **100-08904**

HOMOGENEOUS AREA: **24**
MATERIAL DESCRIPTION: **12" x 12" Tan Floor Tile w/Brown Streaks Mastic**
MATERIAL LOCATION: **Rooms 2, 4, 6, 7, 8 & 15**
MATERIAL QUANTITY: **5488** MATERIAL UNITS: **SF**
DAMAGE QUANTITY: **0** DAMAGE UNITS: **SF**

In accordance with Sections 763.88 and 763.90 of the Asbestos Hazard Emergency Response Act (AHERA) the LEA must select a management planner to review the results of the inspection and assessment and recommend appropriate response actions. The original inspection of the above identified homogeneous area has been reviewed in accordance with Sections 763.88 and 763.90 with the following recommendations.

The RESPONSE ACTION recommendation is:

COMMENTS:

Management Planner's Signature: _____



Date: **08/13/2013**

K:\CPS 2013\1013 Three Years/Asst Director/Region 9\CICS - Wrightwood Campus\CICS - Wrightwood Building A - First Floor East.dwg

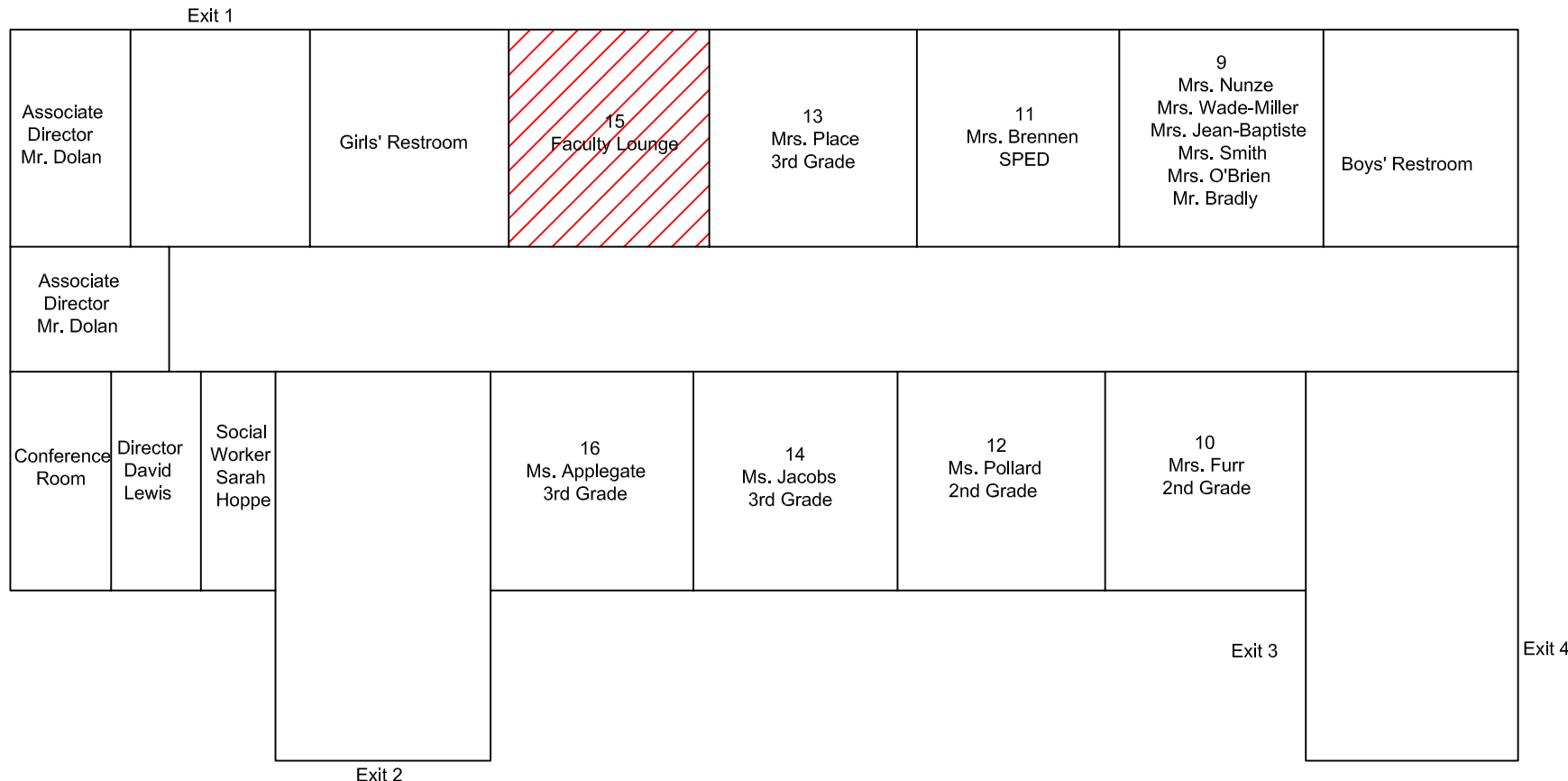

ASBESTOS REINSPECTION KEY NOTES:

 HA-24 Mastic Associated with 12" x 12" Tan Floor Tile with Brown Streak

CICS - Wrightwood Building A - First Floor East
2013 Asbestos Reinspection

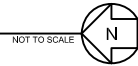

CLIENT:
Chicago Public Schools
125 South Clark Street,
Chicago, Illinois 60603

PROJECT NAME:
2013 AHERA Reinspection
CICS-Wrightwood
8130 South California Avenue
Chicago, IL 60652

SHEET NAME:
CICS - Wrightwood Building A
- First Floor East- HA-24

INSPECTED BY:
Douglas McCormick

IDPH License #:100- 08904

DRAWN BY: KF	DATE: 8/15/2013	CHECKED BY: DM
REVISED BY:	DATE:	CHECKED BY:
REVISED BY:	DATE:	CHECKED BY:
REVISED BY:	DATE:	CHECKED BY:

Carnow, Conibear & Assoc., Ltd.
Environmental Consulting Services
600 W. Van Buren St., Suite 500, Chicago, IL 60607
t: 312.782.4486 f: 312.782.5145
www.ccaltd.com

CARNOW CONIBEAR

CCA PROJECT NUMBER
A32013-0001-434

DATE
08/15/2013

SHEET NUMBER
HA-24

K:\CPS\2013\013 Three Years/One Day/Regular SIC\CICS - Wrightwood Campus\CICS - Wrightwood Building B - First Floor West.dwg

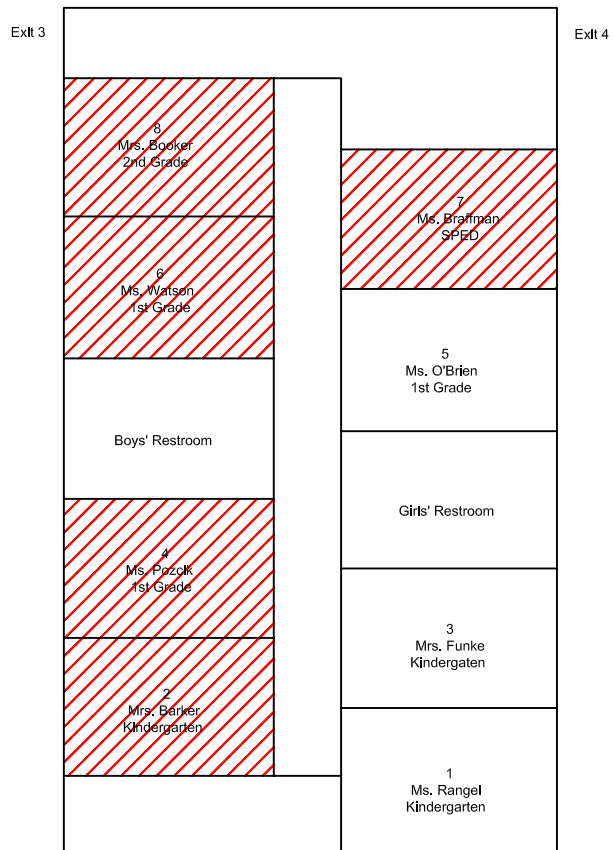

ASBESTOS REINSPECTION KEY NOTES:

 HA-24 Mastic Associated with 12" x 12" Tan with Floor Tile Brown Streaks

CICS - Wrightwood Building B - First Floor West
2013 Asbestos Reinspection



CLIENT: Chicago Public Schools 125 South Clark Street, Chicago, Illinois 60603	PROJECT NAME: 2013 AHERA Reinspection CICS-Wrightwood 8130 South California Avenue Chicago, IL 60652	SHEET NAME: CICS - Wrightwood Building B - First Floor West - HA-24	DRAWN BY: KF	DATE: 8/15/2013	CHECKED BY: DM	CCA PROJECT NUMBER A32013-0001-434
			REVISD BY:	DATE:	CHECKED BY:	
INSPECTED BY: Douglas McCormick			IDPH License #: 100- 08904			DATE 08/15/2013
Carnow, Conibear & Assoc., Ltd. Environmental Consulting Services 600 W. Van Buren St., Suite 500, Chicago, IL 60607 t: 312.782.4486 f: 312.782.5145 www.ccaltd.com						SHEET NUMBER HA-24



Chicago Public Schools

Carnow, Conibear and Associates

2013 AHERA REINSPECTION

Inspector Assessment Form (New Homogeneous Area)

LEA NAME: **Chicago Public Schools** UNIT NUMBER: **66381** BUIDLING ID: **3180**
CITY/STATE: **Chicago, Illinois** AHERA INSPECTOR: **Douglas McCormick**
SCHOOL NAME: **Chicago International Charter - Wrightwood** INSPECTION DATE: **8/13/2013**
ADDRESS: **8130 S. California Ave.** IDPH LICENSE NO: **100-08904**

INFORMATION FROM CURRENT INSPECTION

HOMOGENEOUS AREA: **25**
MATERIAL DESCRIPTION: **1' x 1' White Ceiling Tile w/Deep Fissures**
MATERIAL LOCATION: **Rooms 1-8, 25-27 & 30-32**
MATERIAL QUANTITY: **11000** MATERIAL UNITS: **SF**
MATERIAL CATEGORY: **MISC** FRIABLE: **Yes**
ASBESTOS TYPE: **Assumed**
DISTURBANCE POTENTIAL: **MODERATE** CONDITION:
AHERA DAMAGE CATEGORY: **6 ACBM with the potential for damage**
ACCESSIBILITY: **Within Reach** DAMAGE REASON:
DAMAGE QUANTITY: **0** DAMAGE REASON:
DAMAGE UNITS: **SF**
COMMENTS:

Inspector's Signature: _____ Date: 08/13/2013

Chicago Public Schools

Carnow, Conibear and Associates

2013 AHERA REINSPECTION

Management Planner Review Form

LEA NAME: **Chicago Public Schools** UNIT NUMBER: **66381** BUILDING ID: **3180**
CITY/STATE: **Chicago, Illinois** MANAGEMENT PLANNER: **Todd Huffer**
SCHOOL NAME: **Chicago International Charter - Wrightwood** REVIEW DATE: **8/13/2013**
ADDRESS: **8130 S. California Ave.** IDPH LICENSE NO: **100-08904**

HOMOGENEOUS AREA: **25**

MATERIAL DESCRIPTION: **1' x 1' White Ceiling Tile w/Deep Fissures**

MATERIAL LOCATION: **Rooms 1-8, 25-27 & 30-32**

MATERIAL QUANTITY: **11000**

MATERIAL UNITS:

SF

DAMAGE QUANTITY: **0**

DAMAGE UNITS:

SF

In accordance with Sections 763.88 and 763.90 of the Asbestos Hazard Emergency Response Act (AHERA) the LEA must select a management planner to review the results of the inspection and assessment and recommend appropriate response actions. The original inspection of the above identified homogeneous area has been reviewed in accordance with Sections 763.88 and 763.90 with the following recommendations.

The RESPONSE ACTION recommendation is:

COMMENTS:

Management Planner's Signature: _____



Date: **08/13/2013**

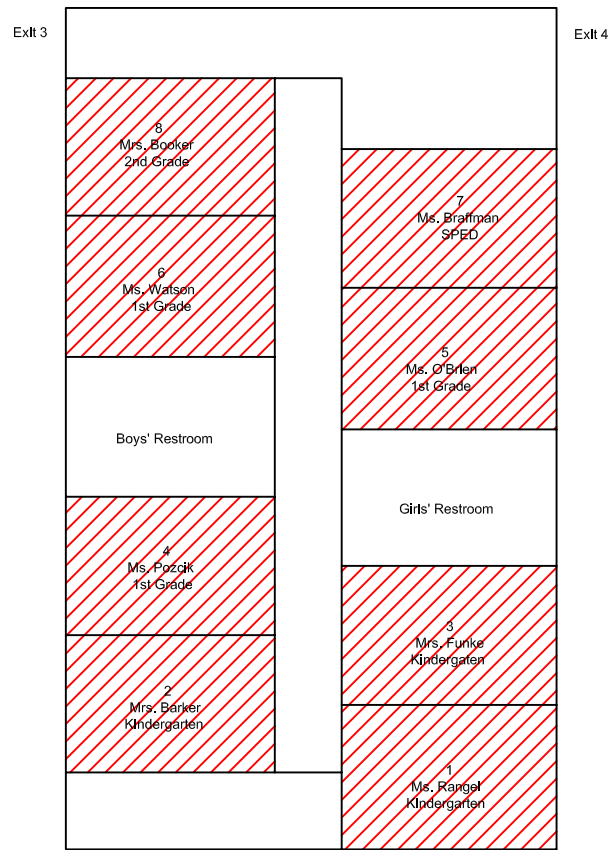

ASBESTOS REINSPECTION KEY NOTES:

 HA-25 1'x1' White Ceiling Tile with Deep Fissures

CICS - Wrightwood Building B - First Floor West
2013 Asbestos Reinspection

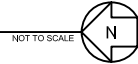

CLIENT:
Chicago Public Schools
125 South Clark Street,
Chicago, Illinois 60603

PROJECT NAME:
2013 AHERA Reinspection
CICS-Wrightwood
8130 South California Avenue
Chicago, IL 60652

SHEET NAME:
CICS - Wrightwood Building B
- First Floor West - HA-25

INSPECTED BY:
Douglas McCormick

DRAWN BY: KF	DATE: 8/15/2013	CHECKED BY: DM
REVISED BY:	DATE:	CHECKED BY:
REVISED BY:	DATE:	CHECKED BY:
REVISED BY:	DATE:	CHECKED BY:

IDPH License #:100- 08904

Carnow, Conibear & Assoc., Ltd.
Environmental Consulting Services
600 W. Van Buren St., Suite 500, Chicago, IL 60607
t: 312.782.4486 f: 312.782.5145
www.ccaltd.com



CCA PROJECT NUMBER
A32013-0001-434

DATE
08/15/2013

SHEET NUMBER

HA-25

K:\SPS\2013\2013 Three Year\Asst Drafting\Region 9\CICS - Wrightwood Campus\CICS - Wrightwood Building B - Second Floor West.dwg

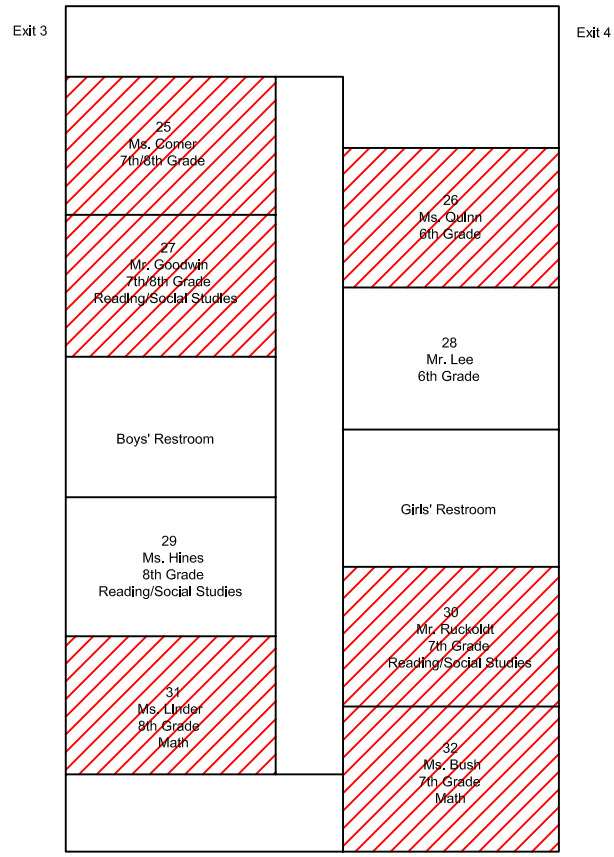

ASBESTOS REINSPECTION KEY NOTES:

HA-25 1' x 1' White Ceiling Tile with Deep Fissures

CICS - Wrightwood Building B - Second Floor West
2013 Asbestos Reinspection

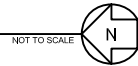

CLIENT:
Chicago Public Schools
125 South Clark Street,
Chicago, Illinois 60603

PROJECT NAME:
2013 AHERA Reinspection
CICS-Wrightwood
8130 South California Avenue
Chicago, IL 60652

SHEET NAME:
CICS - Wrightwood Building B
- Second Floor West - HA-25

INSPECTED BY:
Douglas McCormick

DRAWN BY: KF	DATE: 8/15/2013	CHECKED BY: DM
REVISED BY:	DATE:	CHECKED BY:
REVISED BY:	DATE:	CHECKED BY:
REVISED BY:	DATE:	CHECKED BY:

IDPH License #:100- 08904

Carnow, Conibear & Assoc., Ltd.
Environmental Consulting Services
600 W. Van Buren St., Suite 500, Chicago, IL 60607
t: 312.782.4486 f: 312.782.5145
www.ccaltd.com

**CARNOW
CONIBEAR**

CCA PROJECT NUMBER A32013-0001-434
DATE 08/15/2013
SHEET NUMBER HA-25

Chicago Public Schools

Carnow, Conibear and Associates

2013 AHERA REINSPECTION

Inspector Assessment Form (New Homogeneous Area)

LEA NAME: **Chicago Public Schools** UNIT NUMBER: **66381** BUIDLING ID: **3180**
CITY/STATE: **Chicago, Illinois** AHERA INSPECTOR: **Douglas McCormick**
SCHOOL NAME: **Chicago International Charter - Wrightwood** INSPECTION DATE: **8/13/2013**
ADDRESS: **8130 S. California Ave.** IDPH LICENSE NO: **100-08904**

INFORMATION FROM CURRENT INSPECTION

HOMOGENEOUS AREA: **22**
MATERIAL DESCRIPTION: **12" x 12" Beige Floor Tile w/Gray Streaks Mastic**
MATERIAL LOCATION: **Rooms 10, 14, 17, 22 & 24**
MATERIAL QUANTITY: **3600** MATERIAL UNITS: **SF**
MATERIAL CATEGORY: **MISC** FRIABLE: **No**
ASBESTOS TYPE: **Assumed**
DISTURBANCE POTENTIAL: **MODERATE** CONDITION:
AHERA DAMAGE CATEGORY: **6 ACBM with the potential for damage**
ACCESSIBILITY: **Within Reach** DAMAGE REASON:
DAMAGE QUANTITY: DAMAGE REASON:
DAMAGE UNITS: **SF**
COMMENTS:

Inspector's Signature: _____ Date: 08/13/2013

Chicago Public Schools

Carnow, Conibear and Associates

2013 AHERA REINSPECTION

Management Planner Review Form

LEA NAME: **Chicago Public Schools** UNIT NUMBER: **66381** BUILDING ID: **3180**
CITY/STATE: **Chicago, Illinois** MANAGEMENT PLANNER: **Todd Huffer**
SCHOOL NAME: **Chicago International Charter - Wrightwood** REVIEW DATE: **8/13/2013**
ADDRESS: **8130 S. California Ave.** IDPH LICENSE NO: **100-08904**

HOMOGENEOUS AREA: **22**
MATERIAL DESCRIPTION: **12" x 12" Beige Floor Tile w/Gray Streaks Mastic**
MATERIAL LOCATION: **Rooms 10, 14, 17, 22 & 24**
MATERIAL QUANTITY: **3600** MATERIAL UNITS: **SF**
DAMAGE QUANTITY: DAMAGE UNITS: **SF**

In accordance with Sections 763.88 and 763.90 of the Asbestos Hazard Emergency Response Act (AHERA) the LEA must select a management planner to review the results of the inspection and assessment and recommend appropriate response actions. The original inspection of the above identified homogeneous area has been reviewed in accordance with Sections 763.88 and 763.90 with the following recommendations.

The RESPONSE ACTION recommendation is:

COMMENTS:

Management Planner's Signature:  Date: **08/13/2013**

Exit 1

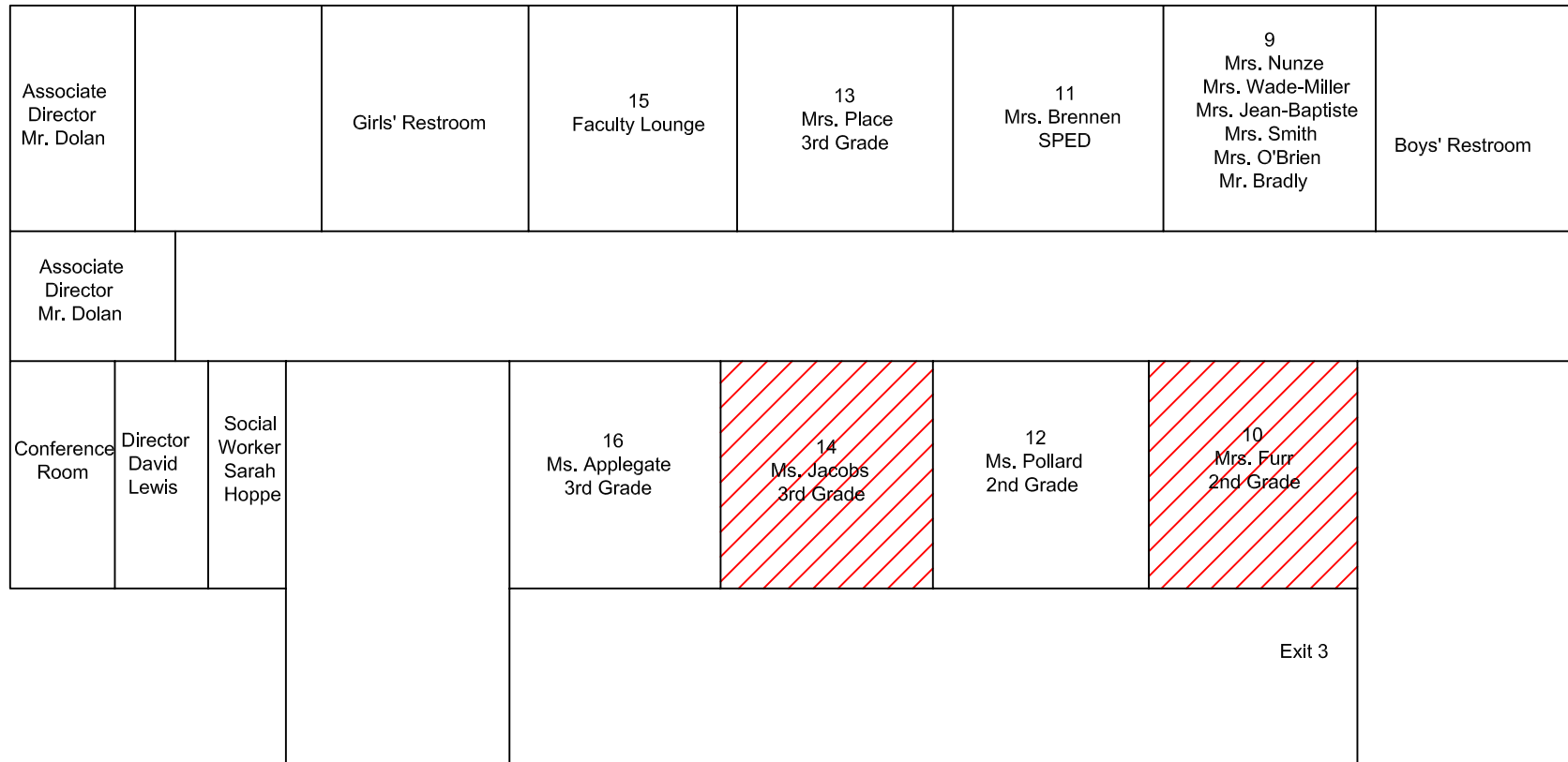

Exit 2

Exit 3

Exit 4

ASBESTOS REINSPECTION KEY NOTES:

 HA-22 Mastic Associated with 12" x 12" Beige Floor Tile with Grey Streaks

CICS - Wrightwood Building A - First Floor East
2013 Asbestos Reinspection

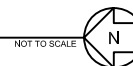

NOT TO SCALE

CLIENT:
Chicago Public Schools
125 South Clark Street,
Chicago, Illinois 60603

PROJECT NAME:
2013 AHERA Reinspection
CICS-Wrightwood
8130 South California Avenue
Chicago, IL 60652

SHEET NAME:
CICS- Wrightwood Building A
- First Floor East - HA-22

INSPECTED BY:
Douglas McCormick

DRAWN BY: KF	DATE: 8/15/2013	CHECKED BY: DM
REVISED BY:	DATE:	CHECKED BY:
REVISED BY:	DATE:	CHECKED BY:
REVISED BY:	DATE:	CHECKED BY:

IDPH License #:100- 08904

Carnow, Conibear & Assoc., Ltd.
Environmental Consulting Services
600 W. Van Buren St., Suite 500, Chicago, IL 60607
t: 312.782.4486 f: 312.782.5145
www.ccailltd.com



CCA PROJECT NUMBER
A32013-0001-434

DATE: 08/15/2013

SHEET NUMBER

HA-22

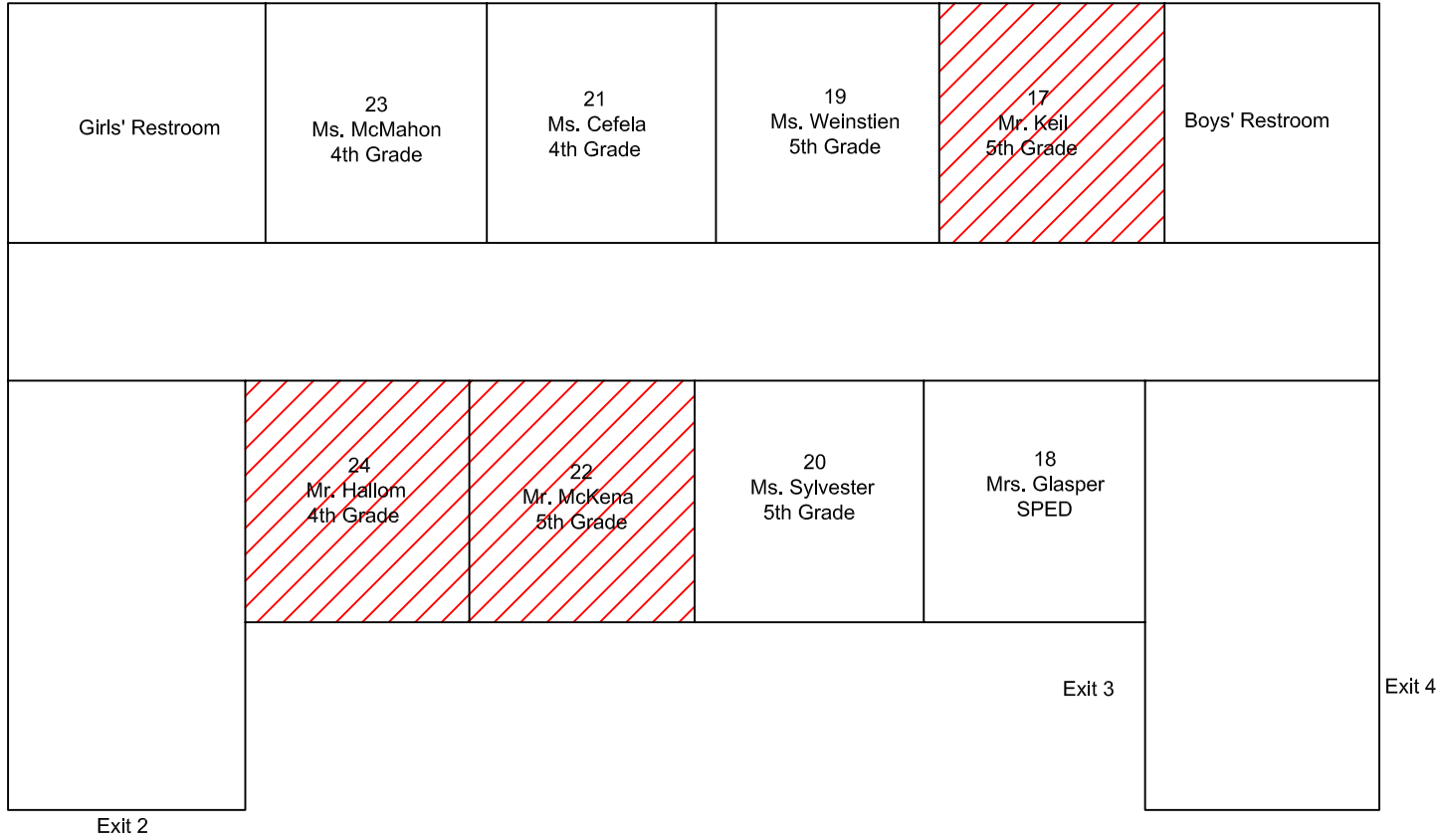

ASBESTOS REINSPECTION KEY NOTES:

 HA-22 Mastic Associated with 12" x 12" Beige Floor Tile with Grey Streaks

CICS - Wrightwood Building A - Second Floor East
2013 Asbestos Reinspection

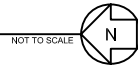

CLIENT:
Chicago Public Schools
125 South Clark Street,
Chicago, Illinois 60603

PROJECT NAME:
2013 AHERA Reinspection
CICS-Wrightwood
8130 South California Avenue
Chicago, IL 60652

SHEET NAME:
CICS - Wrightwood Building A
- Second Floor East - HA-22

INSPECTED BY:
Douglas McCormick

DRAWN BY: KF	DATE: 8/15/2013	CHECKED BY: DM
REVISED BY:	DATE:	CHECKED BY:
REVISED BY:	DATE:	CHECKED BY:
REVISED BY:	DATE:	CHECKED BY:

IDPH License #:100- 08904

Carnow, Conibear & Assoc., Ltd.
Environmental Consulting Services
600 W. Van Buren St., Suite 500, Chicago, IL 60607
t: 312.782.4486 f: 312.782.5145
www.ccalltd.com



CCA PROJECT NUMBER
A32013-0001-434

DATE
08/15/2013

SHEET NUMBER

HA-22

Chicago Public Schools

Carnow, Conibear and Associates

2013 AHERA REINSPECTION

Inspector Assessment Form (New Homogeneous Area)

LEA NAME: **Chicago Public Schools** UNIT NUMBER: **66381** BUILDING ID: **3180**
CITY/STATE: **Chicago, Illinois** AHERA INSPECTOR: **Douglas McCormick**
SCHOOL NAME: **Chicago International Charter - Wrightwood** INSPECTION DATE: **8/13/2013**
ADDRESS: **8130 S. California Ave.** IDPH LICENSE NO: **100-08904**

INFORMATION FROM CURRENT INSPECTION

HOMOGENEOUS AREA: **26**
MATERIAL DESCRIPTION: **12" x 12" Dark Gray Floor Tile w/Black Streaks**
MATERIAL LOCATION: **Rooms 1, 3, 5, 9, 13, 16 & 26-27**
MATERIAL QUANTITY: **5488** MATERIAL UNITS: **SF**
MATERIAL CATEGORY: **MISC** FRIABLE: **No**
ASBESTOS TYPE: **Assumed**
DISTURBANCE POTENTIAL: **MODERATE** CONDITION:
AHERA DAMAGE CATEGORY: **6 ACBM with the potential for damage**
ACCESSIBILITY: **Within Reach** DAMAGE REASON:
DAMAGE QUANTITY: **0** DAMAGE REASON:
DAMAGE UNITS: **SF**
COMMENTS:

Inspector's Signature: _____ Date: 08/13/2013

Chicago Public Schools

Carnow, Conibear and Associates

2013 AHERA REINSPECTION

Management Planner Review Form

LEA NAME: **Chicago Public Schools** UNIT NUMBER: **66381** BUILDING ID: **3180**
CITY/STATE: **Chicago, Illinois** MANAGEMENT PLANNER: **Todd Huffer**
SCHOOL NAME: **Chicago International Charter - Wrightwood** REVIEW DATE: **8/13/2013**
ADDRESS: **8130 S. California Ave.** IDPH LICENSE NO: **100-08904**

HOMOGENEOUS AREA: **26**
MATERIAL DESCRIPTION: **12" x 12" Dark Gray Floor Tile w/Black Streaks**
MATERIAL LOCATION: **Rooms 1, 3, 5, 9, 13, 16 & 26-27**
MATERIAL QUANTITY: **5488** MATERIAL UNITS: **SF**
DAMAGE QUANTITY: **0** DAMAGE UNITS: **SF**

In accordance with Sections 763.88 and 763.90 of the Asbestos Hazard Emergency Response Act (AHERA) the LEA must select a management planner to review the results of the inspection and assessment and recommend appropriate response actions. The original inspection of the above identified homogeneous area has been reviewed in accordance with Sections 763.88 and 763.90 with the following recommendations.

The RESPONSE ACTION recommendation is:

COMMENTS:

Management Planner's Signature: _____



Date: **08/13/2013**

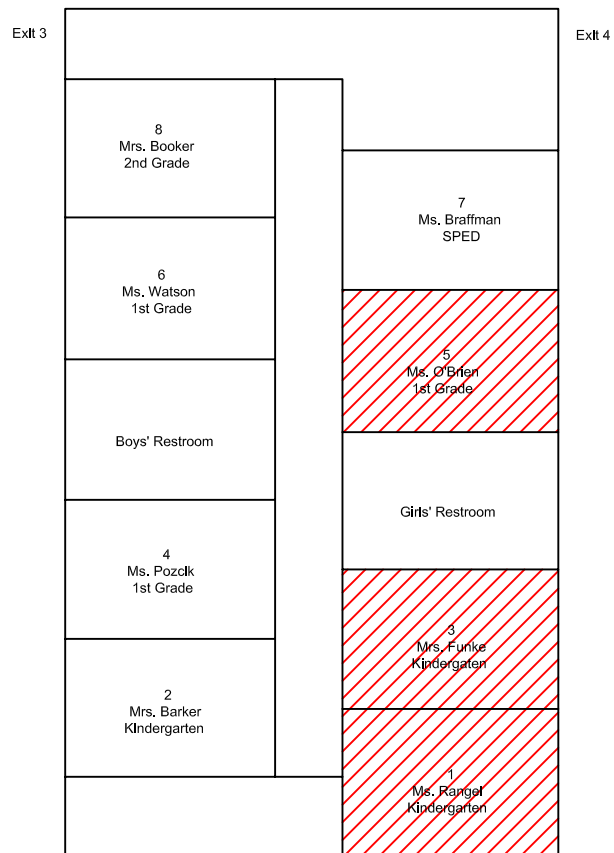

ASBESTOS REINSPECTION KEY NOTES:

 HA-26 12" x 12" Dark Grey Floor Tile with Black Streaks

CICS - Wrightwood Building B - First Floor West
2013 Asbestos Reinspection

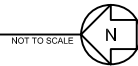

CLIENT:
Chicago Public Schools
125 South Clark Street,
Chicago, Illinois 60603

PROJECT NAME:
2013 AHERA Reinspection
CICS-Wrightwood
8130 South California Avenue
Chicago, IL 60652

SHEET NAME:
CICS - Wrightwood Building B
- First Floor West - HA-26

INSPECTED BY:
Douglas McCormick

DRAWN BY: KF	DATE: 8/15/2013	CHECKED BY: DM
REVISED BY:	DATE:	CHECKED BY:
REVISED BY:	DATE:	CHECKED BY:
REVISED BY:	DATE:	CHECKED BY:

IDPH License #:100- 08904

Carnow, Conibear & Assoc., Ltd.
Environmental Consulting Services
600 W. Van Buren St., Suite 500, Chicago, IL 60607
t: 312.782.4486 f: 312.782.5145
www.ccaatd.com



CCA PROJECT NUMBER
A32013-0001-434

DATE
08/15/2013

SHEET NUMBER
HA-26

C:\CPS 2011\2013 Three Year\Asst District\Region 5\CICS-Wrightwood Campus\CICS - Wrightwood Building B - First Floor West.dwg

C:\PS 2013\03 Three Year\Asst Dir\Region 5\CICS-Wrightwood Campus\CICS-Wrightwood Building A-First Floor East.dwg

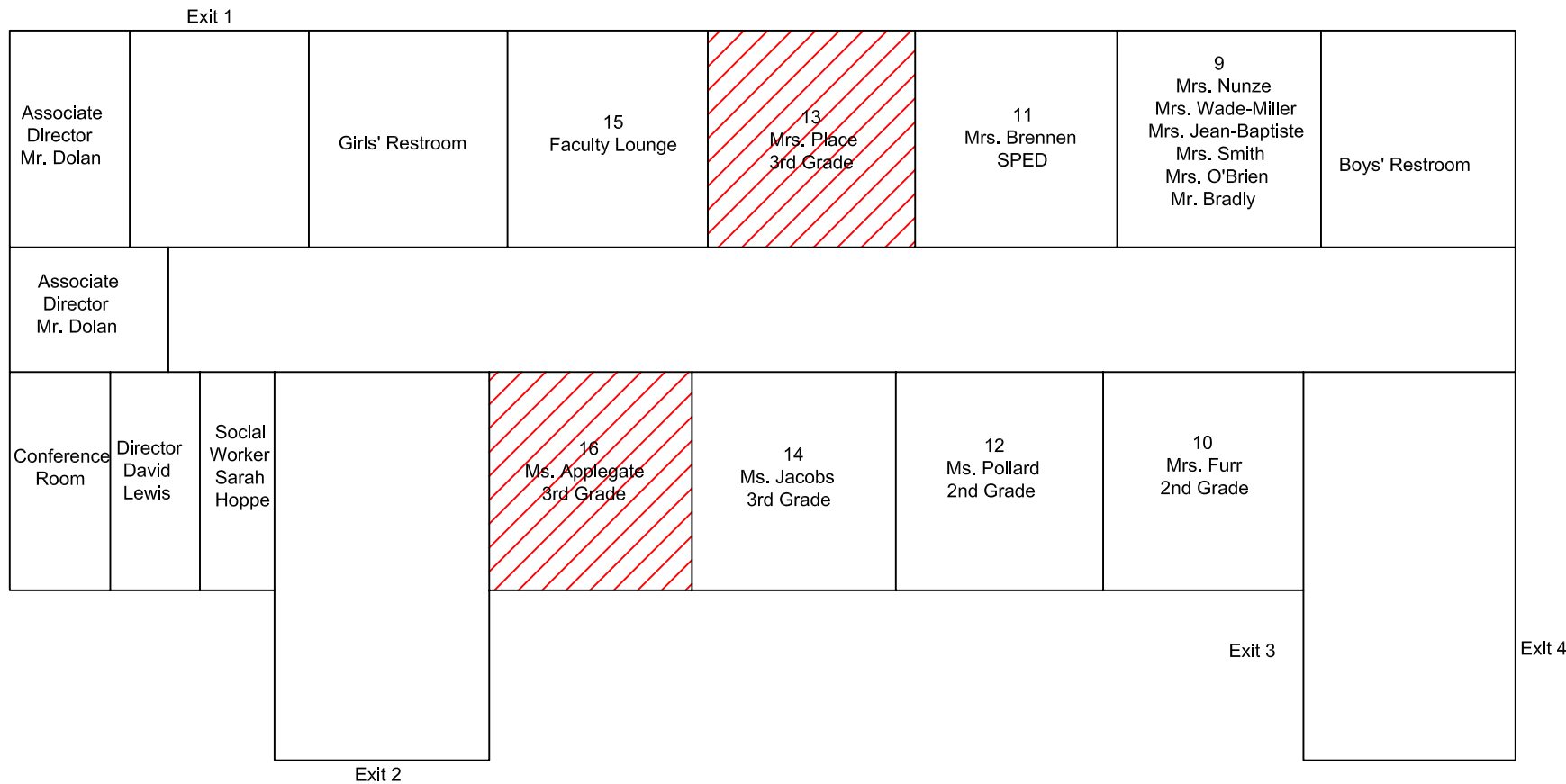

ASBESTOS REINSPECTION KEY NOTES:

 HA-26 12" x 12" Dark Grey Floor Tile with Black Streaks

CICS - Wrightwood Building A - First Floor East
2013 Asbestos Reinspection

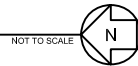

NOT TO SCALE

CLIENT:
Chicago Public Schools
125 South Clark Street,
Chicago, Illinois 60603

PROJECT NAME:
2013 AHERA Reinspection
CICS-Wrightwood
8130 South California Avenue
Chicago, IL 60652

SHEET NAME:
CICS- Wrightwood Building A
- First Floor East - HA-26

INSPECTED BY:
Douglas McCormick

DRAWN BY: KF DATE: 8/15/2013 CHECKED BY: DM
REVISED BY: DATE: CHECKED BY:
REVISED BY: DATE: CHECKED BY:

IDPH License #:100- 08904

Carnow, Conibear & Assoc., Ltd.
Environmental Consulting Services
600 W. Van Buren St., Suite 500, Chicago, IL 60607
t: 312.782.4486 f: 312.782.5145
www.ccalltd.com

**CARNOW
CONIBEAR**

CCA PROJECT NUMBER
A32013-0001-434

DATE
08/15/2013

SHEET NUMBER
HA-26

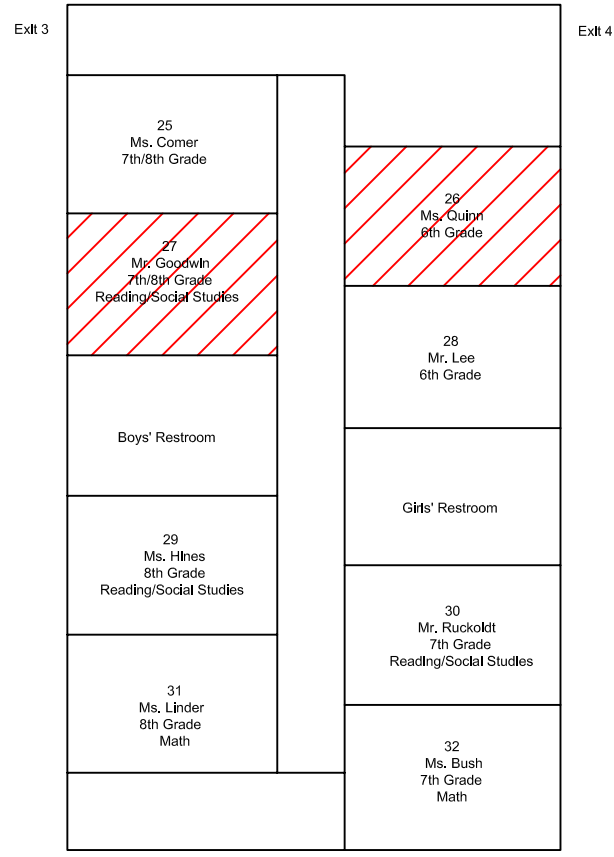

ASBESTOS REINSPECTION KEY NOTES:

 HA-26 12" x 12" Dark Grey Floor Tile with Black Streaks

CICS - Wrightwood Building B - Second Floor West
2013 Asbestos Reinspection

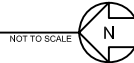

CLIENT:
Chicago Public Schools
125 South Clark Street,
Chicago, Illinois 60603

PROJECT NAME:
2013 AHERA Reinspection
CICS-Wrightwood
8130 South California Avenue
Chicago, IL 60652

SHEET NAME:
CICS - Wrightwood Building B
- Second Floor West - HA-26

INSPECTED BY:
Douglas McCormick

DRAWN BY: KF	DATE: 8/15/2013	CHECKED BY: DM
REVISED BY:	DATE:	CHECKED BY:
REVISED BY:	DATE:	CHECKED BY:
REVISED BY:	DATE:	CHECKED BY:

IDPH License #:100- 08904

Carnow, Conibear & Assoc., Ltd.
Environmental Consulting Services
600 W. Van Buren St., Suite 500, Chicago, IL 60607
t: 312.782.4486 f: 312.782.5145
www.cca ltd.com



CCA PROJECT NUMBER
A32013-0001-434

DATE
08/15/2013

SHEET NUMBER
HA-26

K:\CPS 2013\2013 Three Years Out Drawings\Reglar - CICS - Wrightwood Building B - Second Floor West.dwg

Chicago Public Schools

Carnow, Conibear and Associates

2013 AHERA REINSPECTION

Inspector Assessment Form (New Homogeneous Area)

LEA NAME: **Chicago Public Schools** UNIT NUMBER: **66381** BUILDING ID: **3180**
CITY/STATE: **Chicago, Illinois** AHERA INSPECTOR: **Douglas McCormick**
SCHOOL NAME: **Chicago International Charter - Wrightwood** INSPECTION DATE: **8/13/2013**
ADDRESS: **8130 S. California Ave.** IDPH LICENSE NO: **100-08904**

INFORMATION FROM CURRENT INSPECTION

HOMOGENEOUS AREA: **27**
MATERIAL DESCRIPTION: **12" x 12" Dark Gray Floor Tile w/Black Streaks Mastic**
MATERIAL LOCATION: **Rooms 1, 3, 5, 9, 13, 16 & 26-27**
MATERIAL QUANTITY: **5488** MATERIAL UNITS: **SF**
MATERIAL CATEGORY: **MISC** FRIABLE: **No**
ASBESTOS TYPE: **Assumed**
DISTURBANCE POTENTIAL: **MODERATE** CONDITION:
AHERA DAMAGE CATEGORY: **6 ACBM with the potential for damage**
ACCESSIBILITY: **Within Reach** DAMAGE REASON:
DAMAGE QUANTITY: **0** DAMAGE REASON:
DAMAGE UNITS: **SF**
COMMENTS:

Inspector's Signature: _____ Date: 08/13/2013

Chicago Public Schools

Carnow, Conibear and Associates

2013 AHERA REINSPECTION

Management Planner Review Form

LEA NAME: **Chicago Public Schools** UNIT NUMBER: **66381** BUILDING ID: **3180**
CITY/STATE: **Chicago, Illinois** MANAGEMENT PLANNER: **Todd Huffer**
SCHOOL NAME: **Chicago International Charter - Wrightwood** REVIEW DATE: **8/13/2013**
ADDRESS: **8130 S. California Ave.** IDPH LICENSE NO: **100-08904**

HOMOGENEOUS AREA: **27**
MATERIAL DESCRIPTION: **12" x 12" Dark Gray Floor Tile w/Black Streaks Mastic**
MATERIAL LOCATION: **Rooms 1, 3, 5, 9, 13, 16 & 26-27**
MATERIAL QUANTITY: **5488** MATERIAL UNITS: **SF**
DAMAGE QUANTITY: **0** DAMAGE UNITS: **SF**

In accordance with Sections 763.88 and 763.90 of the Asbestos Hazard Emergency Response Act (AHERA) the LEA must select a management planner to review the results of the inspection and assessment and recommend appropriate response actions. The original inspection of the above identified homogeneous area has been reviewed in accordance with Sections 763.88 and 763.90 with the following recommendations.

The RESPONSE ACTION recommendation is:

COMMENTS:

Management Planner's Signature: _____



Date: **08/13/2013**

KCS/PS 2017/01/13 Three Year/Code Drawings/Region 3/CICS - Wrightwood Campus/CICS - Wrightwood Building B - First Floor West/ang

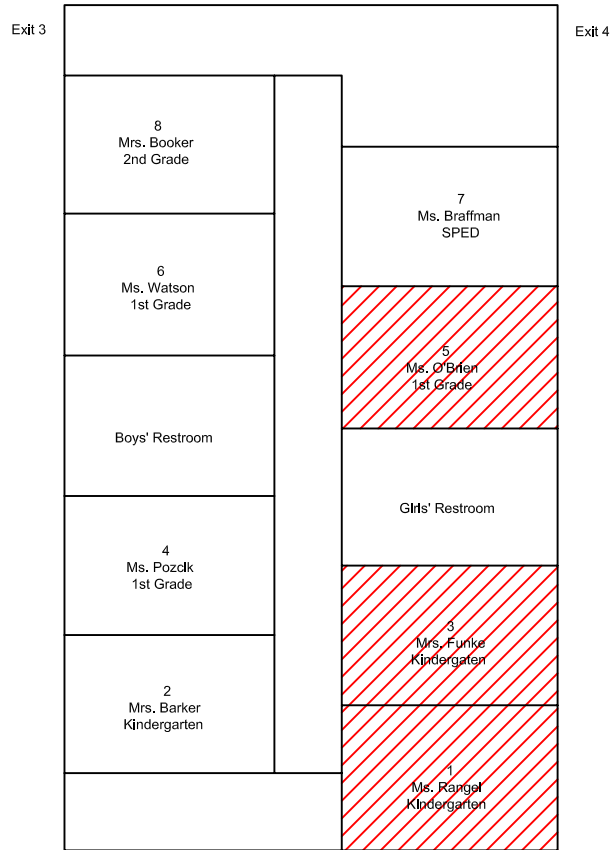

ASBESTOS REINSPECTION KEY NOTES:

HA-27 Mastic Associated with 12" x 12" Dark Grey Floor Tile with Black Streaks

CICS - Wrightwood Building B - First Floor West
2013 Asbestos Reinspection

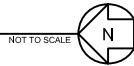

CLIENT:
Chicago Public Schools
125 South Clark Street,
Chicago, Illinois 60603

PROJECT NAME:
2013 AHERA Reinspection
CICS-Wrightwood
8130 South California Avenue
Chicago, IL 60652

SHEET NAME:
CICS - Wrightwood Building B
- First Floor West - HA-27
INSPECTED BY:
Douglas McCormick

DRAWN BY: KF	DATE: 8/15/2013	CHECKED BY: DM
REVISED BY:	DATE:	CHECKED BY:
REVISED BY:	DATE:	CHECKED BY:
REVISED BY:	DATE:	CHECKED BY:

IDPH License #:100- 08904

Carnow, Conibear & Assoc., Ltd.
Environmental Consulting Services
600 W. Van Buren St., Suite 500, Chicago, IL 60607
t: 312.782.4486 f: 312.782.5145
www.ccailld.com

CCA PROJECT NUMBER
A32013-0001-434
DATE
08/15/2013
SHEET NUMBER
HA-27

C:\PS 2011\2013 Three Year\Asst Drawings\Region 5\CICS-Wrightwood Campus\CICS - Wrightwood Building A - First Floor East.dwg

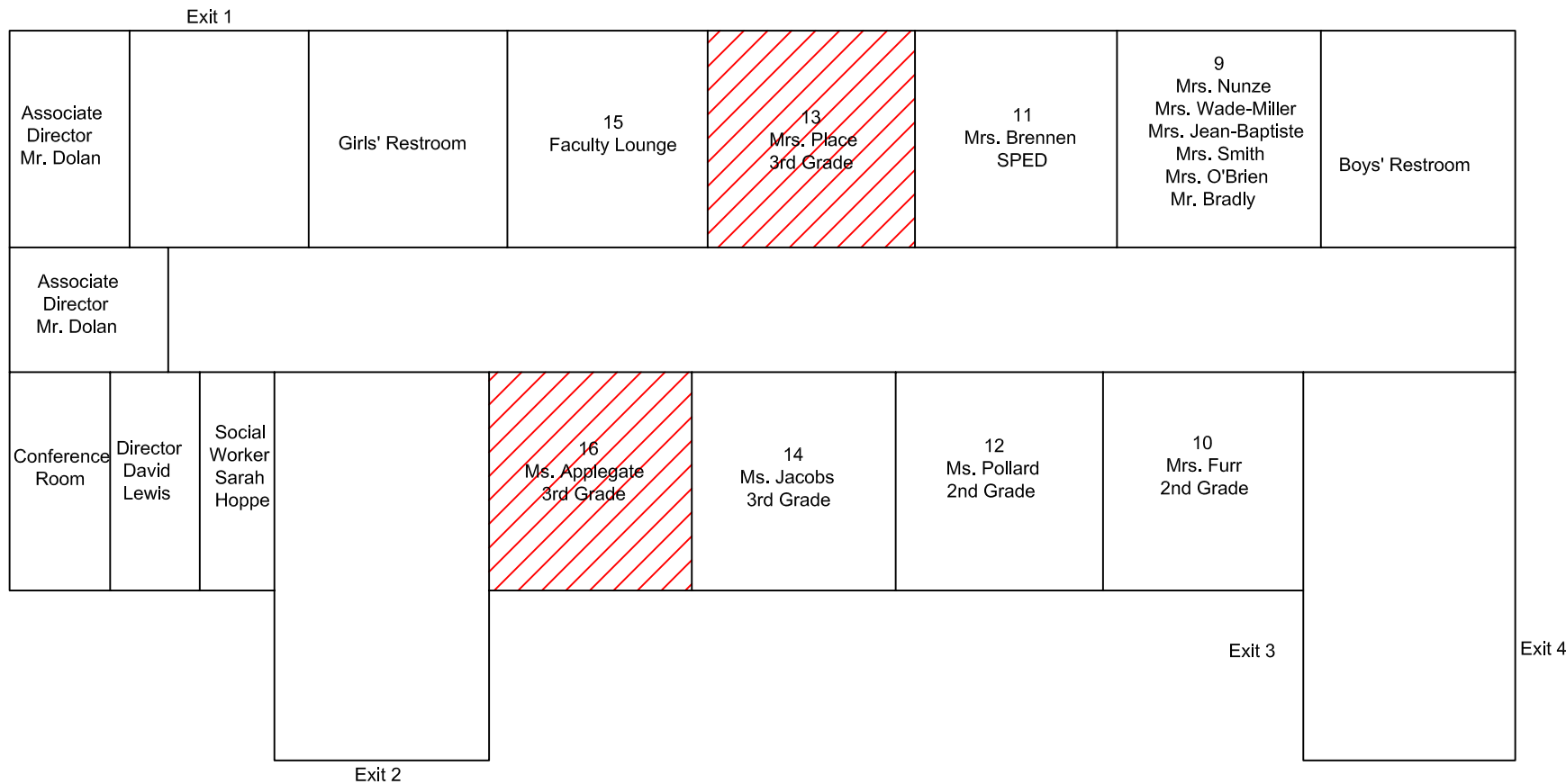

ASBESTOS REINSPECTION KEY NOTES:

 HA-27 Mastic Associated with 12" x 12" Dark Grey Floor Tile with Black Streaks

CICS - Wrightwood Building A - First Floor East
2013 Asbestos Reinspection

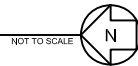

CLIENT:
Chicago Public Schools
125 South Clark Street,
Chicago, Illinois 60603

PROJECT NAME:
2013 AHERA Reinspection
CICS-Wrightwood
8130 South California Avenue
Chicago, IL 60652

SHEET NAME:
CICS - Wrightwood Building A
- First Floor East - HA-27

INSPECTED BY:
Douglas McCormick

DRAWN BY: KF	DATE: 8/15/2013	CHECKED BY: DM
REVISED BY:	DATE:	CHECKED BY:
REVISED BY:	DATE:	CHECKED BY:
REVISED BY:	DATE:	CHECKED BY:

IDPH License #:100- 08904

Carnow, Conibear & Assoc., Ltd.
Environmental Consulting Services
600 W. Van Buren St., Suite 500, Chicago, IL 60607
t: 312.782.4486 f: 312.782.5145
www.ccalltd.com



CCA PROJECT NUMBER
A32013-0001-434

DATE
08/15/2013

SHEET NUMBER
HA-27

C:\CPS\2013\013 Three Years/Class Drawings\Region 9\CICS - Wrightwood Campus\CICS - Wrightwood Building B - Second Floor West.dwg

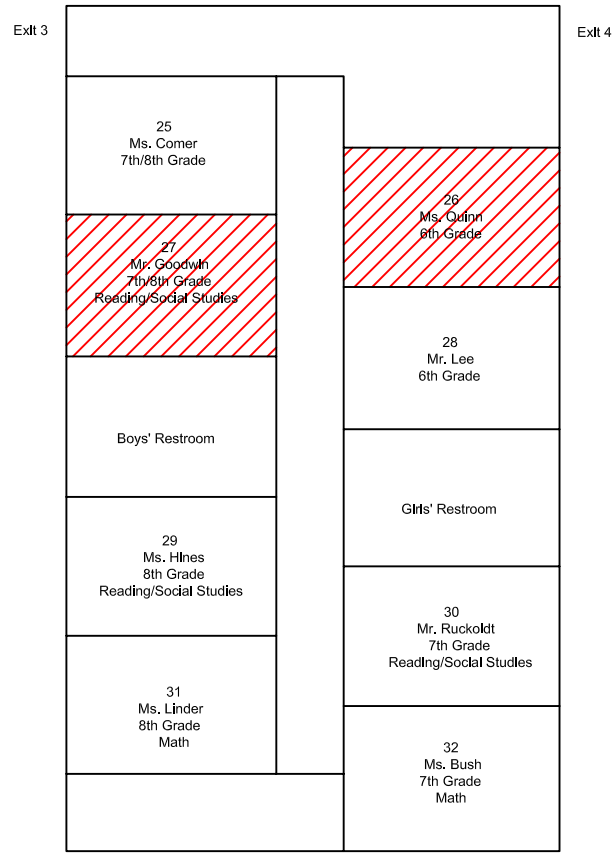

ASBESTOS REINSPECTION KEY NOTES:

 HA-27 Mastic Associated with 12" x 12" Dark Grey Floor Tile with Black Streaks

CICS - Wrightwood Building B - Second Floor West
2013 Asbestos Reinspection

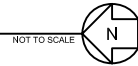

CLIENT: Chicago Public Schools 125 South Clark Street, Chicago, Illinois 60603	PROJECT NAME: 2013 AHERA Reinspection CICS-Wrightwood 8130 South California Avenue Chicago, IL 60652	SHEET NAME: CICS - Wrightwood Building B - Second Floor West - HA-27	DRAWN BY: KF	DATE: 8/15/2013	CHECKED BY: DM	Carnow, Conibear & Assoc., Ltd. Environmental Consulting Services 600 W. Van Buren St., Suite 500, Chicago, IL 60607 t: 312.782.4486 f: 312.782.5145 www.ccailld.com	CCA PROJECT NUMBER A32013-0001-434
			REVISD BY:	DATE:	CHECKED BY:		DATE: 08/15/2013
INSPECTED BY: Douglas McCormick			IDPH License #: 100- 08904				SHEET NUMBER HA-27

Chicago Public Schools

Carnow, Conibear and Associates

2013 AHERA REINSPECTION

Inspector Assessment Form (New Homogeneous Area)

LEA NAME: **Chicago Public Schools** UNIT NUMBER: **66381** BUILDING ID: **3180**
CITY/STATE: **Chicago, Illinois** AHERA INSPECTOR: **Douglas McCormick**
SCHOOL NAME: **Chicago International Charter - Wrightwood** INSPECTION DATE: **8/13/2013**
ADDRESS: **8130 S. California Ave.** IDPH LICENSE NO: **100-08904**

INFORMATION FROM CURRENT INSPECTION

HOMOGENEOUS AREA: **21**
MATERIAL DESCRIPTION: **12" x 12" Beige Floor Tile w/Gray Streaks**
MATERIAL LOCATION: **Rooms 10, 14, 17, 22 & 24**
MATERIAL QUANTITY: **3600** MATERIAL UNITS: **SF**
MATERIAL CATEGORY: **MISC** FRIABLE: **No**
ASBESTOS TYPE: **Assumed**
DISTURBANCE POTENTIAL: **MODERATE** CONDITION:
AHERA DAMAGE CATEGORY: **6 ACBM with the potential for damage**
ACCESSIBILITY: **Within Reach** DAMAGE REASON:
DAMAGE QUANTITY: DAMAGE REASON:
DAMAGE UNITS: **SF**
COMMENTS:

Inspector's Signature: _____ Date: 08/13/2013

Chicago Public Schools

Carnow, Conibear and Associates

2013 AHERA REINSPECTION

Management Planner Review Form

LEA NAME: **Chicago Public Schools** UNIT NUMBER: **66381** BUILDING ID: **3180**
CITY/STATE: **Chicago, Illinois** MANAGEMENT PLANNER: **Todd Huffer**
SCHOOL NAME: **Chicago International Charter - Wrightwood** REVIEW DATE: **8/13/2013**
ADDRESS: **8130 S. California Ave.** IDPH LICENSE NO: **100-08904**

HOMOGENEOUS AREA: **21**
MATERIAL DESCRIPTION: **12" x 12" Beige Floor Tile w/Gray Streaks**
MATERIAL LOCATION: **Rooms 10, 14, 17, 22 & 24**
MATERIAL QUANTITY: **3600** MATERIAL UNITS: **SF**
DAMAGE QUANTITY: DAMAGE UNITS: **SF**

In accordance with Sections 763.88 and 763.90 of the Asbestos Hazard Emergency Response Act (AHERA) the LEA must select a management planner to review the results of the inspection and assessment and recommend appropriate response actions. The original inspection of the above identified homogeneous area has been reviewed in accordance with Sections 763.88 and 763.90 with the following recommendations.

The RESPONSE ACTION recommendation is:

COMMENTS:

Management Planner's Signature:  _____ Date: **08/13/2013** _____

K/CSPS 2013/013 Three Years/Car Drawing/Region: CICS/CICS - Wrightwood Campus/CICS - Wrightwood Building A - First Floor East/ing

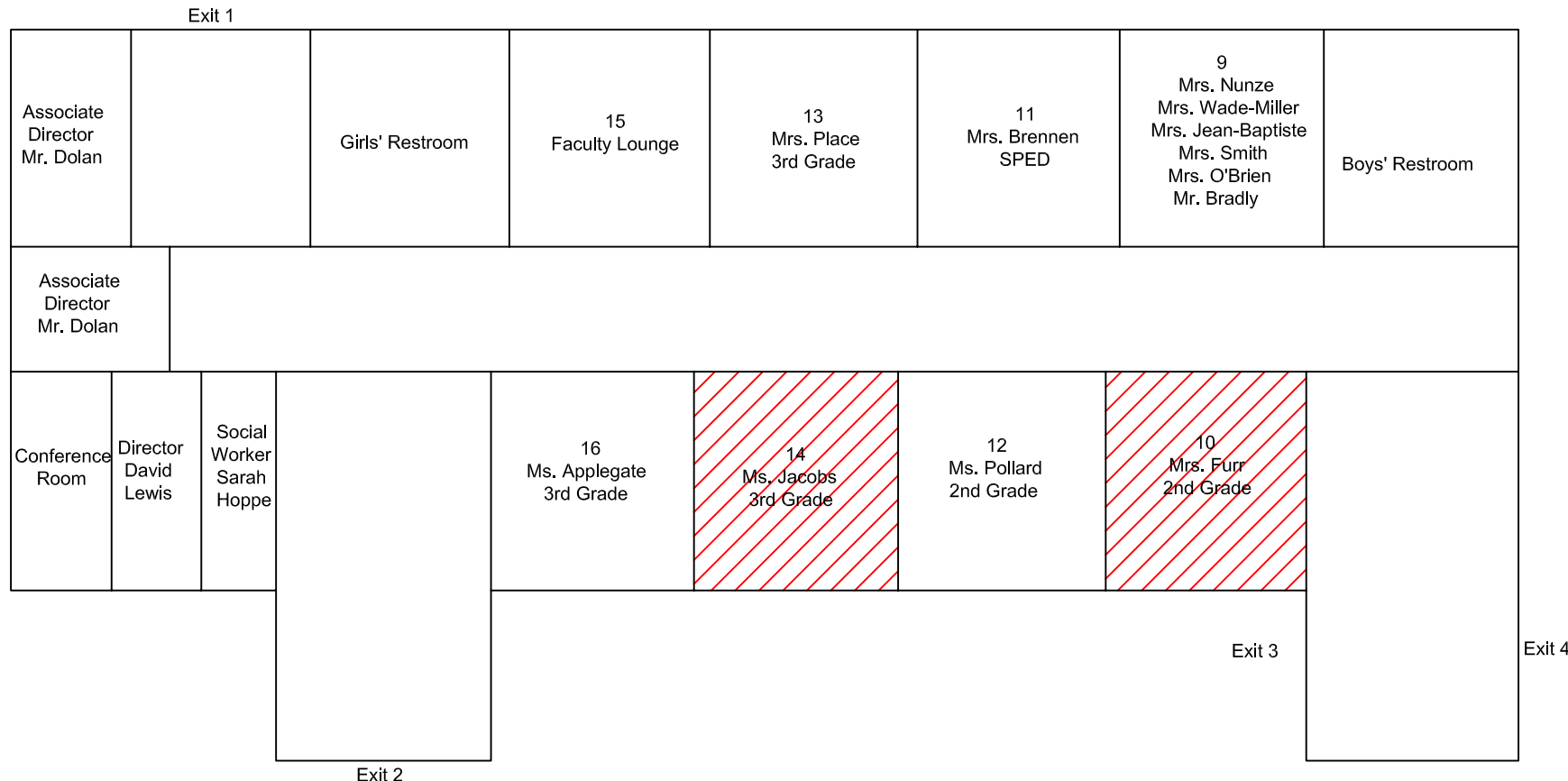

ASBESTOS REINSPECTION KEY NOTES:

 HA-21 12" x 12" Beige Floor Tile with Grey Streaks

CICS - Wrightwood Building A - First Floor East
2013 Asbestos Reinspection

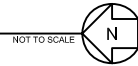

CLIENT:
Chicago Public Schools
125 South Clark Street,
Chicago, Illinois 60603

PROJECT NAME:
2013 AHERA Reinspection
CICS-Wrightwood
8130 South California Avenue
Chicago, IL 60652

SHEET NAME:
CICS - Wrightwood Building A
- First Floor East - HA-21

INSPECTED BY:
Douglas McCormick

IDPH License #:100- 08904

DRAWN BY: KF	DATE: 8/15/2013	CHECKED BY: DM
REVISED BY:	DATE:	CHECKED BY:
REVISED BY:	DATE:	CHECKED BY:
REVISED BY:	DATE:	CHECKED BY:

Carnow, Conibear & Assoc., Ltd.
Environmental Consulting Services
600 W. Van Buren St., Suite 500, Chicago, IL 60607
t: 312.782.4486 f: 312.782.5145
www.cca ltd.com

**CARNOW
CONIBEAR**

CCA PROJECT NUMBER
A32013-0001-434

DATE
08/15/2013

SHEET NUMBER
HA-21

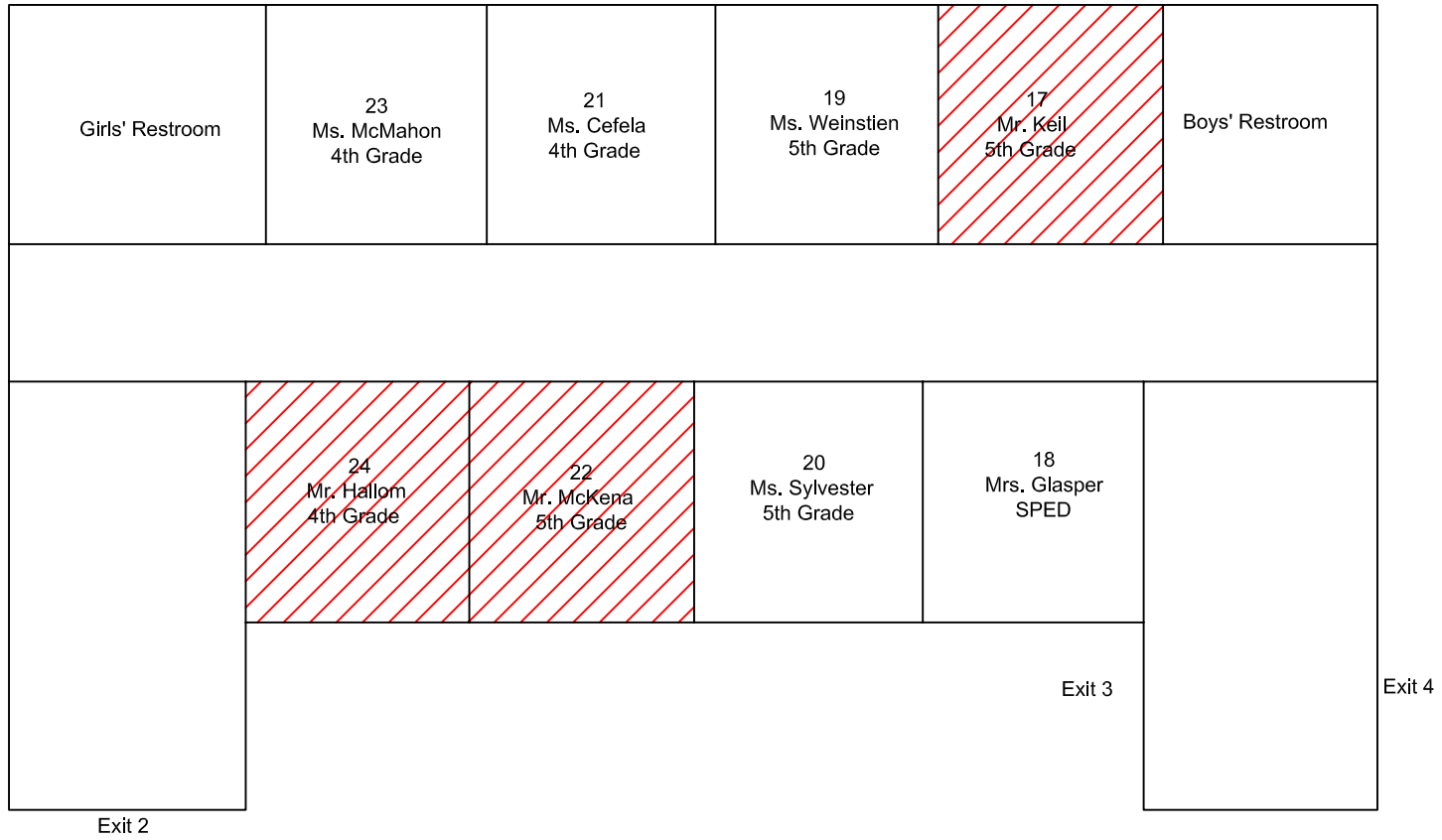

ASBESTOS REINSPECTION KEY NOTES:

 HA-21 12" x 12" Beige Floor Tile with Grey Streaks

CICS - Wrightwood Building A - Second Floor East
2013 Asbestos Reinspection



CLIENT: Chicago Public Schools 125 South Clark Street, Chicago, Illinois 60603	PROJECT NAME: 2013 AHERA Reinspection CICS-Wrightwood 8130 South California Avenue Chicago, IL 60652	SHEET NAME: CICS - Wrightwood Building A - Second Floor East - HA-21 INSPECTED BY: Douglas McCormick	DRAWN BY: KF REVISD BY: DATE:	DATE: 8/15/2013 DATE:	CHECKED BY: DM CHECKED BY:	CCA PROJECT NUMBER A32013-0001-434 DATE 08/15/2013 SHEET NUMBER HA-21
			REVISD BY: DATE:	DATE:	CHECKED BY:	
			IDPH License #:100- 08904			

Carnow, Conibear & Assoc., Ltd.
Environmental Consulting Services
600 W. Van Buren St., Suite 500, Chicago, IL 60607
t: 312.782.4486 f: 312.782.5145
www.ccaltd.com



APPENDIX B

Inspector and Management Planner Licenses



Occupational Training & Supply, Inc.

7233 Adams Street • Willowbrook, IL 60527 • (630) 655-3900

Douglas M. McCormick

has successfully completed the 4 hour Asbestos Building Inspector Refresher Course and has passed the competency exam with a minimum score of 70%. This course is accredited by the Illinois Department of Public Health and the Indiana Department of Environmental Management for purposes of accreditation in accordance with EPA 40 CFR763, Asbestos Hazard Emergency Response Act (AHERA) and TSCA Title II. This training course complies with the requirements of TSCA Title II and is accredited by the state of Wisconsin Department of Health Services under CH.DHS159, Wisconsin Administration Code.

Asbestos Abatement Building Inspector Refresher

Certificate: BIRWI1210101791

Location: 12304 75th Street Kenosha, WI 53142

Course Date: 10/10/2012

Examination Date: 10/10/2012

Expiration Date: 10/10/2013

Issue Date: 10/10/2012



Kathy DeSalvo, Director

2012

Douglas McCormick
Illinois Licensed Asbestos Inspector, Project Manager, and
Air Sampling Professional

 **ASBESTOS
PROFESSIONAL
LICENSE**

ID NUMBER 100 - 08904	ISSUED 4/4/2012	EXPIRES 05/15/2013
---------------------------------	---------------------------	------------------------------

DOUGLAS M McCORMICK
2001 HABBERTON
PARK RIDGE, IL 60068



Environmental Health

ENDORSEMENTS	TC EXPIRES
INSPECTOR	10/13/2012
PROJECT MANAGER AIR SAMPLING PROFESSIONAL	12/15/2012

Alteration of this license shall result in legal action
This license issued under authority of the State of Illinois
Department of Public Health
This license is valid only when accompanied by a valid
training course certificate.

**CARNOW
CONIBEAR**



Occupational Training & Supply, Inc.

7233 Adams Street • Willowbrook, IL 60527 • (630) 655-3900

Asbestos Building Inspector Refresher

Occupational Training and Supply, Inc. certifies that

Todd Huffer

has successfully completed the 4 hour Asbestos Building Inspector Refresher Course
and has passed the competency exam with a minimum score of 70%. The course is accredited by the Illinois Department
of Public Health and Indiana Department of Environmental Management for purposes of accreditation in accordance
with EPA 10 CFR 763 Asbestos Hazard Emergency Response Act (AHERA) and TSCA Title II.

Certificate: BIR1212042317

Exam Date: 12/4/2012

Course Date: 12/4/2012

Expiration Date: 12/4/2013



Kathy DeSalvo, Director

2012

Todd Huffer

Illinois Licensed Asbestos Inspector, Management Planner,
Project Manager, and Air Sampling Professional

 **ASBESTOS
PROFESSIONAL
LICENSE**

ID NUMBER 100 - 09870	ISSUED 4/4/2012	EXPIRES 05/15/2013
---------------------------------	---------------------------	------------------------------

TODD T HUFFER
918 N WOLCOTT UNIT 6
CHICAGO, IL 60622

Environmental Health

ENDORSEMENTS	TC EXPIRES
INSPECTOR	12/8/2012
MANAGEMENT PLANNER	1/19/2013
PROJECT MANAGER	9/8/2012
AIR SAMPLING PROFESSIONAL	

Alteration of this license shall result in legal action
This license issued under authority of the State of Illinois
Department of Public Health
This license is valid only when accompanied by a valid
training course certificate.

**CARNOW
CONIBEAR**



Occupational Training & Supply, Inc.

7233 Adams Street ♦ Willowbrook, IL 60527 ♦ (630) 655-3900

Asbestos Management Planner Refresher

Occupational Training and Supply, Inc. certifies that

Todd Huffer

has successfully completed the 4 hour Asbestos Management Planner Refresher Course
and has passed the competency exam with a minimum score of 70%. The course is accredited by the Illinois Department of Public Health and Indiana Department of Environmental Management for purposes of accreditation in accordance with EPA 10 CFR 763 Asbestos Hazard Emergency Response Act (AHERA) and TSCA Title II.

Certificate: MPR1302250735

Exam Date: 2/25/2013

Course Date: 2/25/2013

Expiration Date: 2/25/2014

Kathy DeSalvo, Director

2013

APPENDIX C

Laboratory Accreditations

APPENDIX D

Laboratory Results

APPENDIX E

Chain of Custody Forms

Three-Year Reinspection Key to Terms

	CODE	KEY
MATERIAL		
	ACBM	Asbestos Containing Building Materials
MATERIAL CATEGORY		
	MISC	Miscellaneous
	SURF	Surfacing
	TSI	Thermal System Insulation
MATERIAL UNITS		
	LF	Linear Feet
	SF	Square Feet
	CF	Cubic Feet
DAMAGE TYPE		
	Loc	Localized
	Dist	Distributed